

RE-FUELLING PUMP RVP25 SERIES

Rajamane

OIL SKIMMERS

Very ideal for pumping clean liquids for transfer from barrel or tank to overhead tanks, fuel tanks etc

For refuelling of generators, earth moving equipments, Railway engines, lorries, etc.

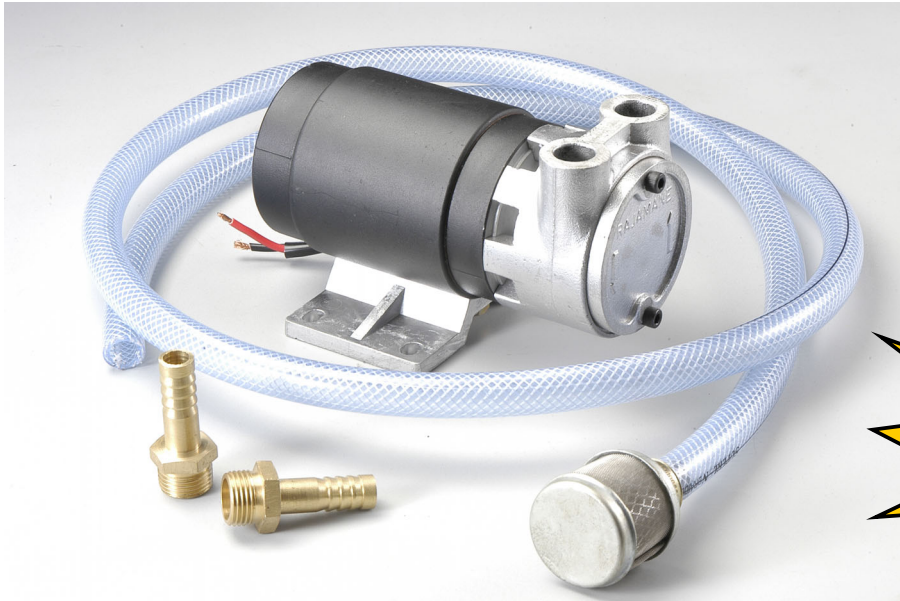

ALSO AVAILABLE FOR VISCIOUS LUBE OILS

CONSTRUCTION

Pump Housing	Al. LM06
Pump Housing Cover	Al LM06
Pump Rotor	NORYL
Pump Vanes	NORYL
Shaft	EN8
Oil Seal	NEOPRIN
O Ring	NEOPRIN

OPTIONS

Pump Housing	C.I / Gunmetal
Pump Housing Cover	C.I / Gunmetal
Shaft	SS410
Flame proof AC motors	
With 12V / 24V DC motor	

APPLICATION

Types of Fluids	- Water
	- Cooling Emulsions
	- Diesel
	- Kerosene
Kinematical Viscosity	- 90mm ² /s
Pumping Temperature	- UPTO 50 C

RVP25 WITH 12/24V DC MOTOR

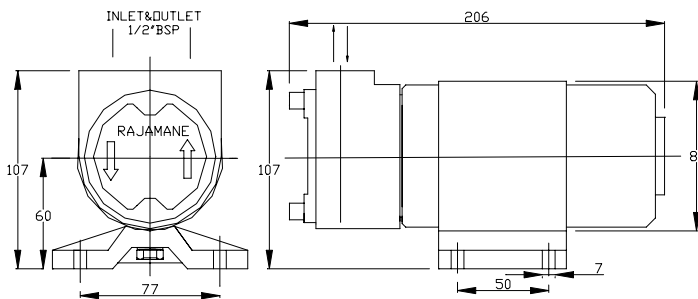

RVP25 WITH SINGLE / THREE PHASE, AC MOTOR

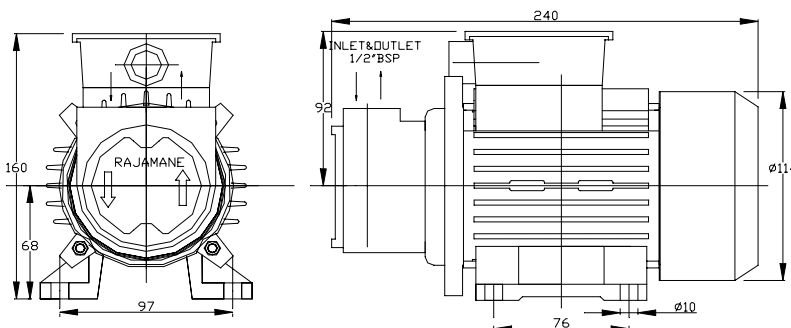

STANDARD KIT

1. Two meter braided pvc suction pipe with strainer
2. In let & Outlet hose nipple to fit 1/2 inch flexible hose pipe
3. On / Off switch with mounting bracket & fuse (for DC motor model only)

PERFORMANCE

Maximum Flow: DC Motor 24LPM
AC Motor 15LPM

Maximum Head: Delivery : 6M
Suction : 2M

Maximum Power : 150W DC
130W AC

For higher Delivery Head please contact factory

RAJAMANE INDUSTRIES PVT LTD
WHITEFIELD ROAD, MAHADEVAPURA POST
BANGALORE - 560048
PH; 080-4365 9000 FAX: 80-28524320
Email : coolantpump@rajamane.com www.rajamane.com

Dealer: