

Coolant Pumps

Coolant Pumps Catalogue



▶ **Machining**

Flooding | Circulating | Grinding |
Chip Conveyor | Filtration

▶ **High Pressure Cooling**

Through Tool | Washing | Filtration

▶ **Oil Skimming**

Belt | Disc

▶ **Refrigeration / Temperature Control**

Printing | Packing | Welding | Mold Temperature

▶ **Media**

Water | Coolant | Chemicals | Oil |
Ink | Varnish | Washing Solution

▶ **Pump with BLDC Motor**

Product of Proven Performance

RECOMMENDATION CHART																										
SNo	SERIES	DRY RUNNING (UPTO 350 MM. DEPTH)	APPLICATION										MEDIUM					CONTAMINATION			IMPELLER TYPE					
			HIGH TEMPERATURE	CHILING	BORING	SAWING	MILLING	TURNING	GRINDING	CIRCULATING	WASHING	EMULSIONS	COOLANT & LBRCTS	WATER	DE IONISED WATER	SOLVENTS	CHEMICALS	COARSE	MEDIUM	FEW	SEMI OPEN	CLOSED	CASTED	SHEET METAL FABRICATED	PERIPHERAL	
1	RV40....250	✓	X	✓	✓	✓	✓	✓	✓	✓	✓	✓	✓	✓	✓	X	X	X		✓	✓	✓	✓			
2	RK275..800	✓	X		✓	✓	✓	✓	✓	✓	X	✓	✓	X	X	X		✓	✓	✓	✓		✓			
3	RK3.5....7		X		✓	✓	✓	✓	✓	✓	X	✓	✓	X	X	X		✓	✓	✓		✓	✓			
4	RKC100....500		X		✓	✓	✓	✓	✓	✓	X	✓	✓	X	X	X		✓	✓	✓		✓	✓			
5	RKM200 RKM300				✓	✓	✓	✓	X	✓	X	✓	✓	X	X	X			X	✓		✓	✓			
6	RKM100,RKM250 RMS400-800	✓	X		✓	✓	✓	✓	✓	✓	X	✓	✓	X	X	X			✓	✓	✓		✓			
7	RR50	✓	✓		✓	✓	✓	✓	✓	✓	X	✓	✓	X	X	X			X	✓			✓		✓	
8	RMB-V-50..100				✓	✓	✓	✓	X	✓	X	✓	✓	X	X	X	X			✓	✓		✓			
9	RKM060, RK 060				✓	✓	✓	✓	✓	✓	✓	✓	✓	✓	✓	X			X	✓			✓			
10	RMH 060, 0250				✓	✓	✓	✓	✓	✓	✓	✓	✓	✓	✓	✓	X			X	✓		✓		✓	
11	RTA		✓	✓	X	X	X	X	X	✓	✓	✓	✓	✓	✓	✓	X				✓					✓
12	RKM 0250, 050			✓						✓	X	✓	✓	✓	X	X			✓	✓		✓	✓			
13	RPP				X	X	X	X	X	✓	X										✓					
14	RTH4 & RTH2			✓	✓	✓	✓	✓	✓	X	✓	✓	✓	X	X					✓		✓		✓		

✓ - USABLE X- PLEASE ASK BEFORE SELECTING

NOTE :	TYPE	PARTICLE SIZE	Percentage of contamination against coolant volume
CONTAMINATION Handled by pumps	COARSE	> 1MM	5%
	MEDIUM	0.2 TO 1 MM	2%
	FEW	< 0.2	< 1%



INDEX

Page 4-5
Technical Details

Page 14
RKM 060 Series

Page 22
RMH060 Series



Page 6-7
RV40-RV250,
RMB-V Series



Page 15
RFP Series



New Page 23
RTAH & RKH
Horizontal Pumps



Page 8
RK115-RK800
Series



Page 16
RKM100 Series



New Page 24
RSP Series
Self Priming Pump



Page 9
RK3.5-RK7
Series



Page 17
RKM200 &
RKM300



Page 25
ROS1 - ROS5
Oil Skimmer



New Page 10
RDP20 & RSB
Series



Page 18
RKM250
Series



Page 26-27
BFS/BFG &
FFS Series



Page 11
RR50
Series



Page 19
RTH2, RTH 4 &
RTH 6 Series



Page 28-29
RPP Pumps
Inline Pumps



Page 12
RTA Series



Page 20
RMS400-800
Series



Page 30
Piston Pumps



Page 13
RKM025 Series



Page 21
RMH250 Series



Page 31
Other Products



Technical Information

I. ELECTRICAL:

- Always connect the 3 phase coolant pumps through suitable OLR or MPCB to avoid motor failures due to overloading, voltage fluctuations and single phasing etc.
- All standard coolant pumps are fitted with Induction motors having specifications as- 415V±10% 50Hz±2% 3 Phase, S1 duty, CL-F/B. ,2800 RPM. The power rating is given against the pump model. Other voltage, insulation Class & frequency are available on request.
- Self cooling motors (TESC) are fitted for coolant pumps with upto 0.18kW rating. These motor body temperature raise have been tested & are within the range specified in class of insulation section. The body temperature of these motors will be within 80°C even when felt very hot by bare hand.
- Temperature rise: All motor temperature rise is as under, based on its class of insulation, in addition to the ambient temperature (room temperature):

Class of Insulation	B	F
Temperature Rise	80°C	120°C

- OLR/MPCB setting:** set the current in these at 10% higher than that on the nameplate, to avoid nuisance tripping caused by variation in loads, voltages, supply frequency, etc. The motors are capable of taking this extra current.
- Frequency Drive:** Most of the motors are suitable for operating through frequency drive, from 0-50 Hz. For overloading with 60 Hz. ask factory.
- Gland Connector** factory fitted is PG11, any other size available on request for specific models only.

8. Connection diagrams:

Standard 3 leads, for direct online start

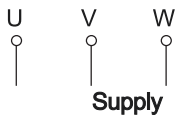

TO CHANGE THE DIRECTION OF ROTATION INTERCHANGE ANY TWO SUPPLY LEADS.

Dual speed- Dhahlender winding:

FOR LOW SPEED: SUPPLY A2B2C2
OPEN A1B1C1
FOR HIGH SPEED: SUPPLY A1B1C1
SHORT A2B2C2

Note: Check direction of rotation in both speeds. The direction must be same in both speeds as shown in the name plate on the pump.

Dual voltage connection :

LOW VOLTAGE

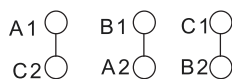

or

FOR LOW VOLTG: SHORT A1C2,B1A2,C1B2
SUPPLY A2,B2,C2
FOR HIGH VOLTG.:SHORT A1B1C1
SUPPLY A2B2C2

or

HIGH VOLTAGE

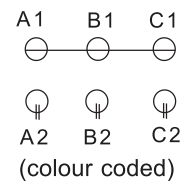

Note: Connection by default is Star. Change the same for low voltage to delta.

Star-delta connection-for 5.5kw & above:

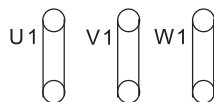
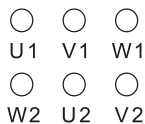

For star/delta starter

For Direct online start

Note: For D.O.L. starting connect in delta. For through starter, remove shorting leads.

Single phase Motor :

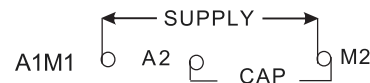

For changing the direction, interchange M1 & M2

9. Current rating: The current rating and efficiency (as per IE2) of the pump motors, against their kW is given below. This table is for 2 pole (2800RPM) motors only. If the pump is fitted with special motor of other RPM, call factory for current details:

Power in kW	Current in A	Efficiency, %
0.08	0.24	NA
0.1	0.34	NA
0.18	0.65	60.4
0.2	0.65	61.9
0.25	0.75	64.8
0.3	0.9	67.1
0.37	0.9	69.5

Power in kW	Current in A	Efficiency, %
0.45	1.2	71.7
0.5	1.35	73
0.54	1.6	73.9
0.75	1.8	77.4
0.9	2.26	78.5
1.1	2.6	79.6
1.3	3	80.5

Power in kW	Current in A	Efficiency, %
1.5	3.4	81.3
1.7	3.5	81.9
2	4	82.7
2.25	4.5	83.3
2.6	5.7	83.9
3	6.5	84.6
3.3	7.2	85

Power in kW	Current in A	Efficiency, %
3.7	8	85.5
4	9	85.8
4.3	9.5	86.1
5.5	10.5	87
7.5	14	88.1
8.5	16	88.6
9	19.5	88.8
10	19.5	89.1

II. MECHANICAL/ HYDRAULIC:

- Coolant pump performance graphs shown in the Catalogue are for water as media, at room temperature only. Pump performance varies +/- 15% on the flow rate & +/-10% on the head
- For best performance of the pumps, maintain minimum & maximum levels as given in the Catalogue
- For multistage coolant pumps, while mounting on the small immersion tanks, ensure that the minimum of two impeller stages are immersed in the liquid. Balance portion of the pump can be mounted on a spacer like distance piece.
- Suction gap:** Maintain minimum suction gap depending on the flow rate being taken- 25 mm for upto 200 LPM flow & 50 mm for upto 800 LPM flow.
- Effect of Viscosity & Specific Gravity of liquids:** The rising viscosity needs more power. As such the standard motors can be used for liquids having 5 CST viscosity & coolant emulsions. Similarly, the rising specific gravity needs more power. This power requirement is linearly proportional to the specific gravity of the liquid. e.g. if 1 kw is required for water, 1.2 kw is recommended for 1.2 specific gravity liquid.

6. Bearing Chart :

Sl. No.	Motor Power In K.w.	Bearing		Remarks	Motor Frame
		Top	Bottom		
1	0.08	6201-2RS	6201-2RS		56
2	0.1	6201-2RS	6201-2RS**	** 6003-2RS - RV40/270, RV40/350	63
3	0.18	6201-2RS	6003-2RS		63
4	0.2	6201-2RS	6204-2RS	RV100/170,RV100/350 - 6204	63
5	0.25	6201-2RS	6205-2RS		71
6	0.30	6201-2RS	6204-2RS	RV160/170,RV160/350 - 6204	71
6	0.37	6202-2RS	6205-2RS		71
7	0.50	6201-2RS	6004-2RS [^]	RV250 -6004	63 IEC
7	0.50	6201-2RS	6204-2RS	RKM120, RV250/170 - 6204	
8	0.54	6202-2RS	6205-2RS		71
9	0.90	6202-2RS	6205-2RS		71 IEC
10	1.1/0.75	6204-2RS	6205-2RS#	# 6206ZZ FOR RK300	80
11	1.5	6205-2RS	6205-2RS*	* 6206ZZ FOR RK400	90
12	2	6205-2RS	6206-2RS		90
13	2.25	6206-2RS	6306-2RS		100
14	3/3.3	6206-2RS	6207-2RS	RTH MOTOR & RMS 402	100
15	3.7/4.0	6306-2RS	6306-2RS@	@ 6207ZZ FOR RK7/RK800	112
16	5.5/7.5	6308-2RS	3308-2RS\$	\$ 3308-Double Groove for RMS Series	132

In Some Models Instead Of ZZ , 2RS Sealed Bearings are also used.

- Terminal box position w.r.t outlet:** The standard options are given below
6 O' clock is the standard position maintained in factory. For any change, mention while ordering the pump.
- For grinding or similar application involving abbrasive dust in the coolant:**
It is recommended to use pumps without bush bearings for such applications. In case of pumps having bush bearings or mechanical seals (see the standard spares list in each page) they have to be ordered with carbide materials.
- On/off cycles:** The standard pumps upto 6 stages are suitable for 40 on/off per hours. Above 6 stages pumps are suitable for 30 on/off per hour. For higher on/off per hour applications, call factory.
- Pipe fittings:** Use always standard G.I. fittings having good radius at bends & elbows to avoid head losses. Do not fit an elbow or reducer nipple immediately at the pump outlet. Take the same pipe as the outlet is as far as possible, to get the best flow/pressure at the end point of piping. Use only parallel (G) threaded fittings with butting face.
- Pressure Boosting Arrangement:** The following diagram shows, how an existing multistage pump can be connected to a Booster pump to enhance the pressure.
- Noise level :** Maxm. 72dB for all models. For RR Series refer catalogue page
- Side suction pumps for outside tank mounting:** These pumps are available for series RKM0250, RKM050, RKM200, RKM300 & RKM060 apart from Horizontal mounting RMH pumps. The schematic diagram is as under. For detailed mounting ask factory. These pumps need priming. Filter (eg. 'Y' Filter) at suction is recommended.
- Spares Ordering:** While ordering spares or pumps, give the full model or frame name along with the si. no. on the name plate. Give any extensions given after frame / model like -13, -121, etc. These indicates the speciality of the product & helps in providing the correct spare or product.
- Units Conversion:** 1mm²/sec = 1cst
10M Head = 1kg/cm² = 1 Bar

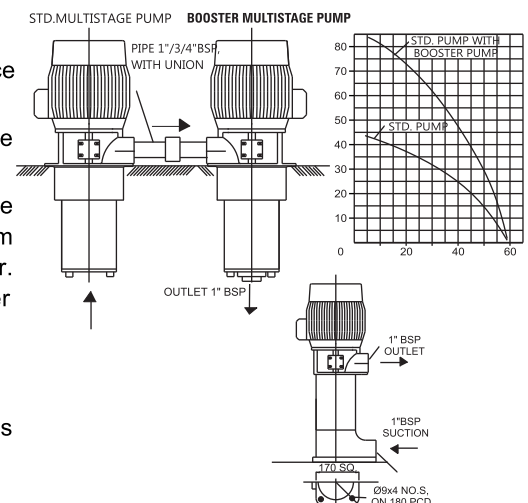
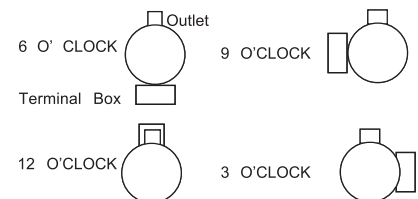

CONVENTIONAL & MONOBLOCK COOLANT PUMP RV40-RV250

CONSTRUCTION		OPTIONS		APPLICATION
Stem	C.I.	Stem	Gunmetal/S.S	Types of Fluids - Water - Cooling Emulsion - Cooling/Cutting Oils
Impeller	Velox553/AL	Impeller	Gunmetal/CI/S.S	
Impeller Cover	Velox553/CI	Impeller Cover	Gunmetal	
Shaft	EN8			
SPECIAL VERSIONS		Shaft	Teflon Coated/S.S.410	Kinematical Viscosity - 90mm ² /s Pumping Temperature - 0-60°C

Available

- * ON/OFF Rotary switch
- * With flame proof motor for hazardous liquids
- * For Frequent ON/OFF Cycles
- * For Any Immersion depth
- * For high viscous liquids
- * To handle Hot Liquids upto 100 C⁰

USED ON

All lathes, Milling, CNC, retrofittings, EDM wire and other conventional machines, Cutting Machines, Printing machines Etc

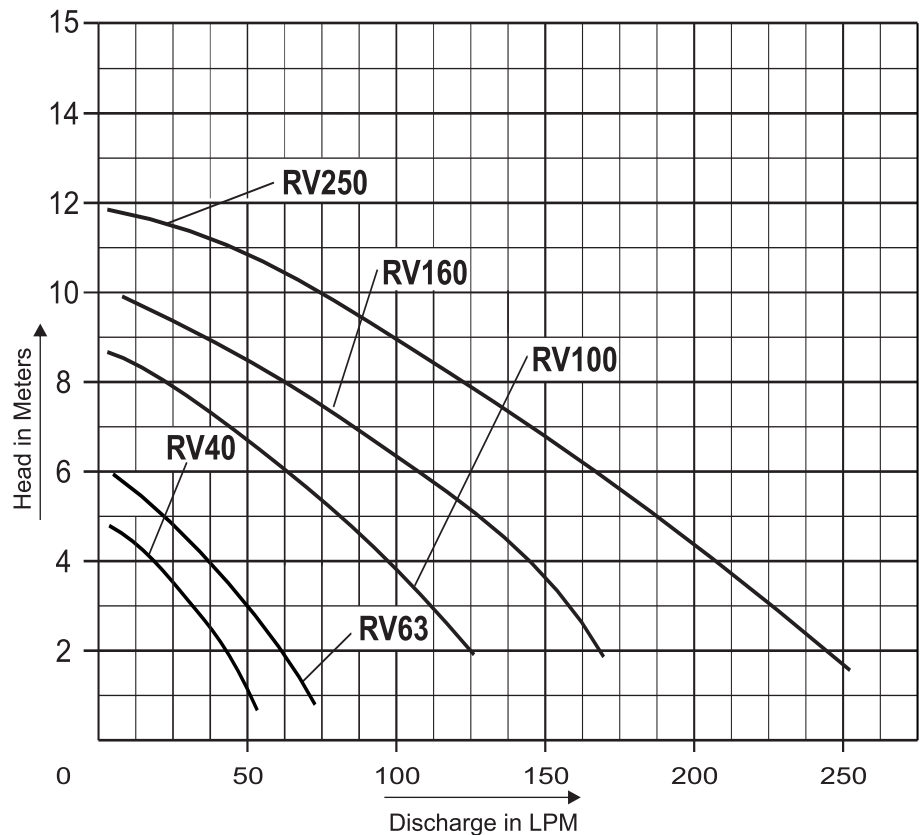
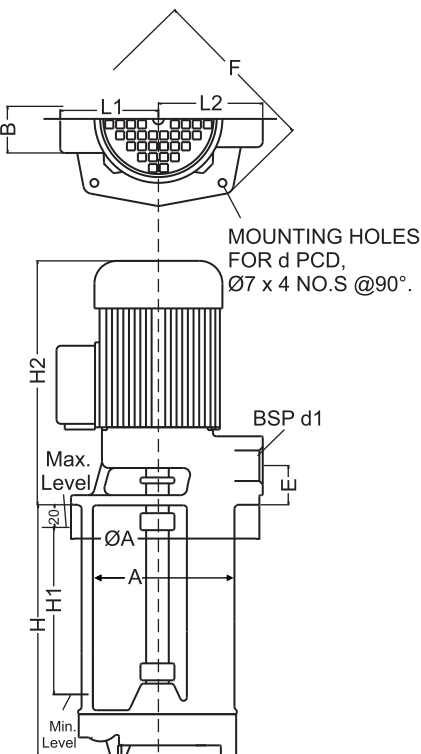
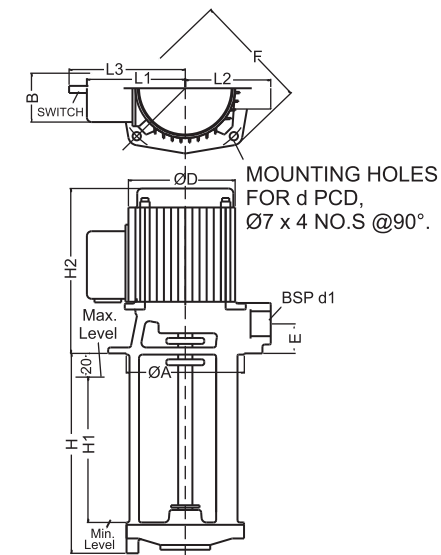

Accessories:

Coolant Tank with pipe set to suit Lathes, Grinding Machines, Drilling Machines available.

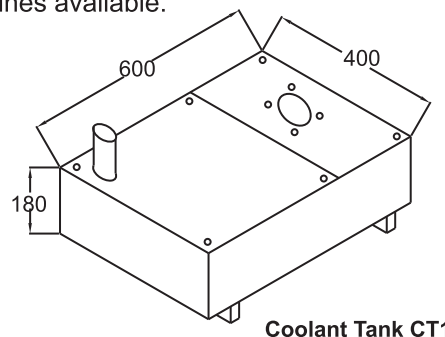

Coolant Tank CT1

SIZE	TYPE	Immersion Depth H	H1 MAX	H2 MAX	A+0 -1	B MAX	D MAX	d -0.2	d1 BSP	E -0	F	L1 MAX	L2	L3	Flow at 2mtr hd ± 15%	Max Hd ± 10%	Kw	Wt in Kg
RV40 #	40/120	120	30	141	100	72	85	115	G $\frac{3}{4}$ "	30	130	90	72	125	40	5	0.1	4.5
	40/170	170	80															4.5
	40/220	220	130	175	100	72	105	115	G $\frac{3}{4}$ "	30	130	95	80	130	40	5	0.1	6
	40/270	270	180															6.7
	40/350	350	260															7.3
RV63 #	63/120	120	30															6.0
	63/170	500	80															6.0
	63/220	220	130	174	100	72	125	115	G $\frac{3}{4}$ "	30	130	95	80	130	63	6	0.18	6.50
	63/270	250	180															7.0
	63/350	350	260															10.0
RV100 #	100/170	170	80															8.25
	100/220	220	130	235	140	72	125	160	G1"	32	180	105	95	130	100	8	0.20	8.50
	100/270	270	180															9.25
RV160 #	160/170	170	80	235														8.50
	160/220	220	130		140	72	125	160	G1"	32	180	105	95	130	160	10	0.3	9.25
	160/270	270	180	217														10
	160/350+	350	260															13
RV250 #	250/170	180	80															11.0
	250/220	230	130															12.0
	250/270	250	180	230	140	70	125	160	G1 $\frac{1}{4}$ "	32	180	105	95	130	250	11	0.5	14.0
	250/270	360	190															15.00
	250/350+	350	260															23
	250/450+	450	350	230	140	72	125	160	G1 $\frac{1}{4}$ "	32	180	105	95	130	250	13	0.54	25

Non Standard Immersion depths are available instep of 180mm for RV40 - RV250
Maximum Immersion depth is 500 mm for RV40/RV63 & 1000 mm for RV100 - RV250

RV Series as per IS: 2161 + H2 Max is 50mm extra -Tank, Pipe set available in standard sizes.

#- Available in all Stainless Steel (SS316) Construction

VERTICAL FOOT MOUNTED RMB-V SERIES

CONSTRUCTION

Stem : C.I. / Impeller : AL. / Impeller Cover : C.I. /
Shaft : EN8 / Mechanical seal : Carbon / Ceramic

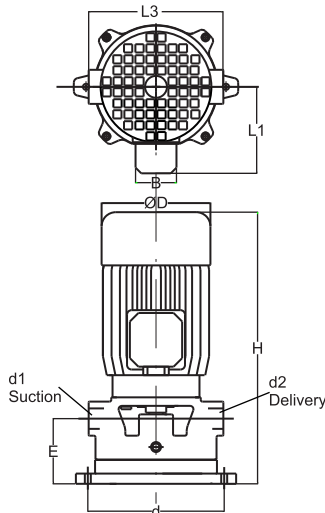

OPTIONS

Stem : Gunmetal / Impeller : C.I./Gunmetal / Impeller Cover : Gunmetal /
Shaft : S.S / Mechanical seal : Carbon / Ceramic

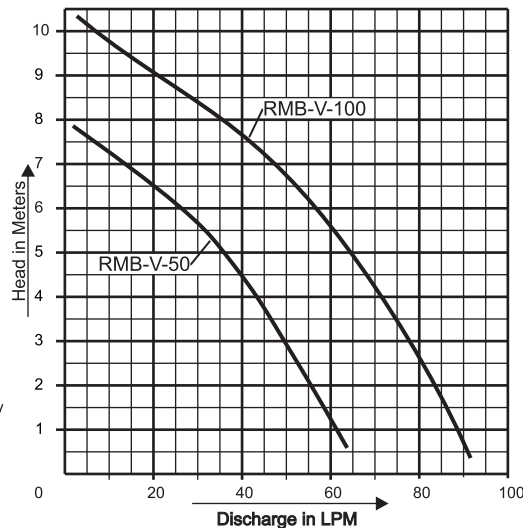

TYPE	H	D	d1	d2	d	E	L3	L1	Kw	Wt. Kg.
RMB-V-50	280	145	G $\frac{3}{4}$ "	G $\frac{3}{4}$ "	160	80	160	120	0.25	14
RMB-V-100	280	145	G1"	G1"	160	110	180	120	0.37	16

NOTE :

- The above shown performance curve is for water, without non-return valve & water level 300MM below the pump suction. Pump delivers higher discharge when connected at tank level (20-30% more), and reduces as the water level drops.
- The pump can prime, following initial priming, upto 400MM, for higher depth upto 600MM a non-return valve is to be used at the delivery side. Use of non-return valve causes a drop of 10% in the performance.
- The suction line must be air tight and avoid the use of foot valve.

* Standard spares : Impeller, Mechanical seal and gasket (sealing) set.

CONVENTIONAL HIGH FLOW COOLANT PUMPS RK 115... RK800

CONSTRUCTION

Stem C.I.
 Impeller C.I.
 Impeller Cover C.I.
 Shaft EN8

OPTIONS

Stem Gunmetal/S.S
 Impeller Gunmetal/S.S
 Impeller Cover Gunmetal
 Shaft Teflon Coated/S.S.410

APPLICATION

Types of Fluids - Water - Cooling Emulsion
 - Cooling/Cutting Oils
 Kinematical Viscosity - 90mm²/s
 Pumping Temperature - 0-80°C

SPECIAL VERSIONS

Available Extra

- * Immersion depth in step of 200mm
- * For high viscous liquids * To handle Hot Liquids upto 100 C

USED ON

All lathes, Milling, CNC, retrofittings, EDM wire. Grinding, Cutting Machines, Printing machines Etc

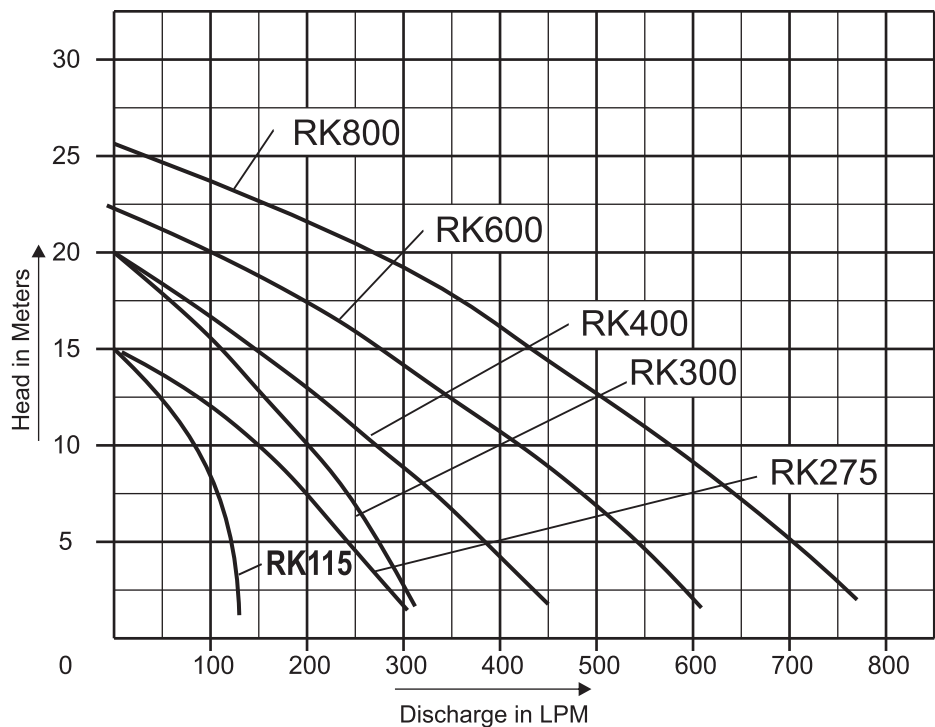
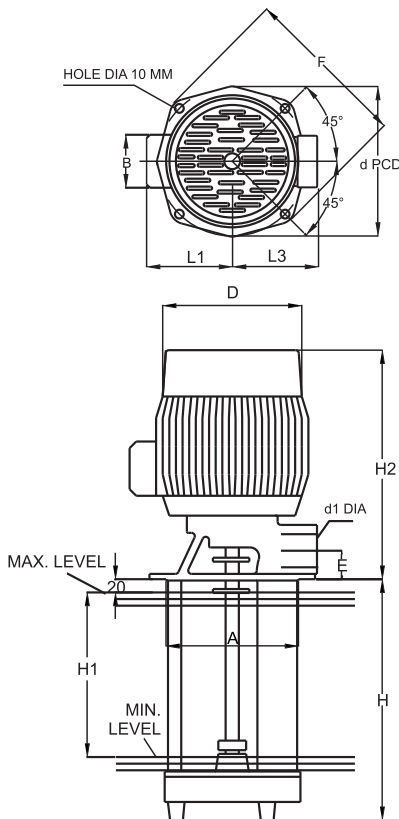

DIMENSIONAL DETAILS

TYPE	Immersion Depth H	H1 Max	H2 Max	A+0 -1	B Max	D Max	d -0.2	d1 BSP	E -0.2	F	L1 Max	L3	Kw	Wt in Kg
RK 115	200	095	230	140	72	125	160	G1"	32	180	105	130	0.3	11.5
	250	145												12.0
	300	195												12.5
RK275	300	220	310	200	82	156	225	G1½"	42	250	130	125	0.9	30
RK300	300	220	310	200	82	156	225	G1½"	42	250	130	126	1.1	30
RK400	300	220	330	200	82	175	225	G1½"	42	250	150	126	1.5	34
RK600	300	220	415	200	82	200	225	G2"	42	250	150	126	2.25	42
RK800	300	220	450	200	82	230	225	G2"	42	250	180	126	3.75	51

* All pumps - RV40-RV250 & RK115 - RK800 with Std. Immersion depth are glandless. They can run dry & will not have air locking problem.

* Non Standard Immersion depths are available instep of 200mm for RK275 - RK800 Maximum Immersion depth is 1000 mm for RK115 & 1200 mm for RK275 - RK800 ask factory for longer than these.

* Standard spares : Impeller (for long immersion pumps, above 300mm) bush/sleeve.

HIGH DISCHARGE PUMP (FLOODING TYPE) RK3.5 TO RK7 & COUPLED SERIES

CONSTRUCTION

Stem	C.I.
Pump Housing	C.I.
Impeller	C.I.
Shaft	EN8
Flange	C.I.
Bush/sleeve	GM/EN9

OPTIONS

Stem	Gunmetal
Pump Housing	Gunmetal
Impeller	Gunmetal
Shaft	Stainless Steel
Bush/sleeve	Carbide/Carbide

APPLICATION

Types of Fluids - Water - Cooling Emulsion
 - Cooling/Cutting Oils
 Kinematical Viscosity - 90mm²/s
 Pumping Temperature - 0-80°C

SPECIAL VERSIONS

- Available
- With Flame Proof Motors to pump hazardous liquids
 - For frequent on/off cycles
 - For any immersion depths
 - For high viscous liquids
 - To handle hot liquids up to 100 °C

USED ON

All CNC machines to flush chips, to transfer fluid for Filtration, Cyclone Filter, Chip Conveyors, EDM Wire cut machines, Heat treatment plants, Grinding machines, Granite and Indoor Fountains.

RKC100 TO 500 Coupled Version

RK3.5 TO RK7

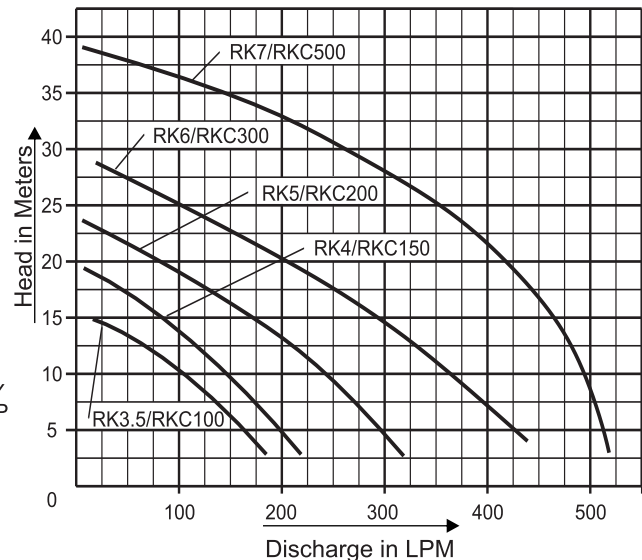
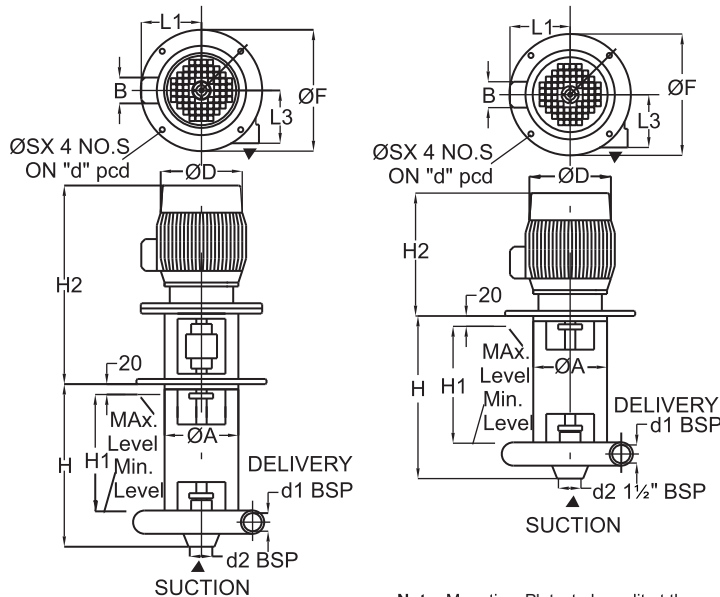

Note: Mounting Plate to be split at the centre, to fit the pump.

DIMENSIONAL DETAILS

TYPE		IMMERSION DEPTH	H1 MAX	H2 MAX		A+0 -1	B MAX	D MAX	d -0.2	d1 BSP	S	F	L1 MAX	INLET BSP	L3	POWER IN KW / HP	Wt in Kg
COUPLED	NON COUPLED			COUPLED	NON COUPLED												
		H								Inch							
RKC-100	RK 3.5/311	311	200	404	236	141	82	156	165	G1"	12	200	126	G1½"	120	0.75/1.0	28
RKC-150	RK 4/311	311	200	420	236	141	82	156	165	G1"	12	200	126	G1½"	120	1.1/1.5	30
RKC-200	RK 5/311	311	200	454	280	141	82	170	165	G1¼"	12	200	135	G1½"	120	1.5/2.0	39
RKC-300	RK 6/311	311	200	485	415	181	82	208	215	G1½"	15	250	155	G1½"	125	2.25/3.0	50
RKC-500	RK 7/311	311	200	590	430	181	82	225	215	G2"	15	250	165	G2½"	125	3.75/5.0	60

- * Standard spares : Impeller, Bush & Sleeve
- * Standard Spares : Impeller, Bush/sleeve for long immersion pumps.
- * Non Standard Immersion depths available upto 1000mm

Service and spares available through our country wide dealers network
 Ask use for more details visit our website : www.rajamane.com



Standard Spares : Impeller, Bush/sleeve for long immersion pumps.

SELF PRIMING PUMP RDP20 – WITH AC/ DC MOTOR

CONSTRUCTION		OPTIONS		APPLICATION	
Body	C.I.	Mechanical Seal	SiC/SiC	Types of Fluids	- Water
Stem	C.I.	Motor	BLDC		- Cooling Emulsions
Impeller	BRONZE		PMDC 12/24 V		- Cooling /Cutting Oils
Impeller Cover	C.I.	Stem	Gun Metal		
Shaft	SS 410			Kinematical Viscosity	- 90mm ² / s
Mechanical Seal	Carbon/Ceramic			Pumping Temperature	- 0 – 100°C

RDP20 WITH AC MOTOR

USED ON Best suited for Pumping Fuel in gensets, used in chilling / Refrigeration units, Automats, Small washing machines, etc.

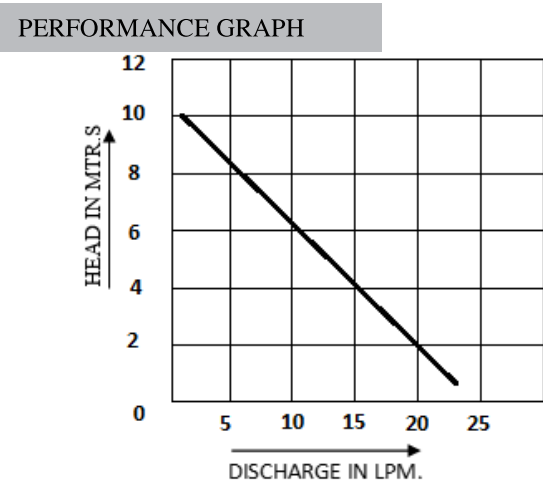
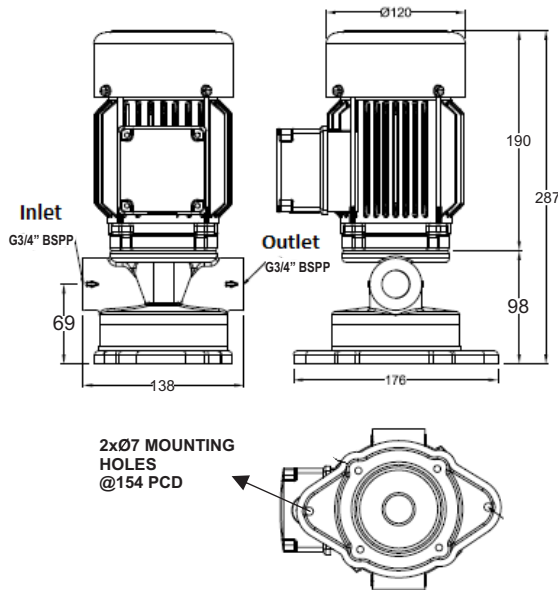

ALL DIMENSIONS ARE IN MM AND RPM AT 2900 RPM

- STANDARD SPARES : IMPELLER, MECHANICAL SEAL

STIRRERS - RSB SERIES

CONSTRUCTION		APPLICATION	USED ON
Impeller	Al./Bronze	Types of Fluids - Water - Coolant Emulsion	Chilling units, Mixing barrels, coolant tanks, etc.
Shaft	SS410	Liquid Temperature - 0-80°C	

- SPECIAL VERSIONS**
- Available with Flame Proof Motors.
 - Any immersion depth Upto 800 mm

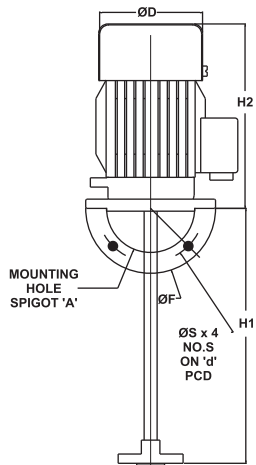

DIMENSIONAL DETAILS

TYPE	H1	H2 MAX	A+0 -1	d PCD	F	S	D MAX	L1 MAX	RPM	POWER (KW/HP)	Weight in Kg.App.
RSB63L	225 275 350	210	95	115	140	10	120	115	1440	0.18/0.25	10
RSB71L	225 275 500	235	110	130	160	10	140	130	960	0.37/0.50	9.5
RSB90L	500 750	280	130	165	200	12	185	145	480	0.25/0.33	25

Supply Voltage 415V, 50HZ, 3PH
Optional RPM 960 available for longer immersion stirrers.

* Standard spares : Impeller

HIGH PRESSURE - LOW IMMERSION RR50 SERIES

CONSTRUCTION

Stem	C.I.
Impeller	Bronze
Impeller Cover	C.I.
Shaft	EN8
Bush Bearing	GM

OPTIONS

Stem	Gunmetal
Impeller Cover	Gunmetal
Shaft	S.S.410
Bush Bearing	Carbon

APPLICATION

Types of Fluids	- Water - Cooling Emulsion - Cooling/Cutting Oils
Kinematical Viscosity	- 90mm ² /s
Pumping Temperature	- 0-80°C
Clear Media	- Prefiltered (50 microns)

SPECIAL VERSIONS

Available

- With flame proof motor for hazardous liquids
- With dual speed motor
- Special versions to handle hot liquids upto 200°C

USED ON

All CNC machines, lathes and machining centres. Best for temperature controlling units in moulding, spindle cooling. Most suited for through tool cooling, deep hole drilling, chilling units and industrial washing machine.

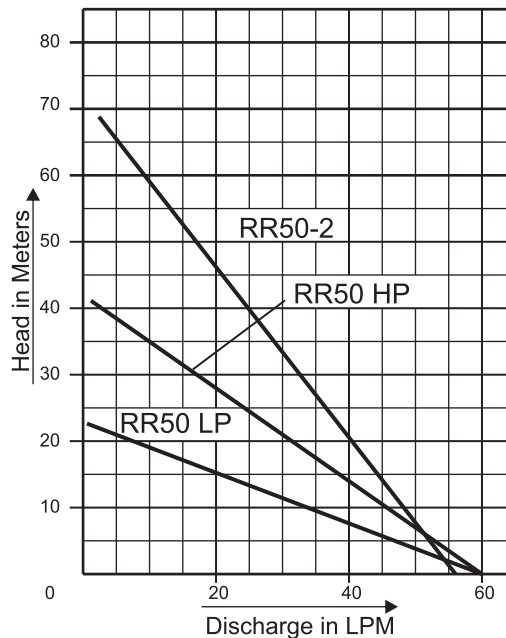
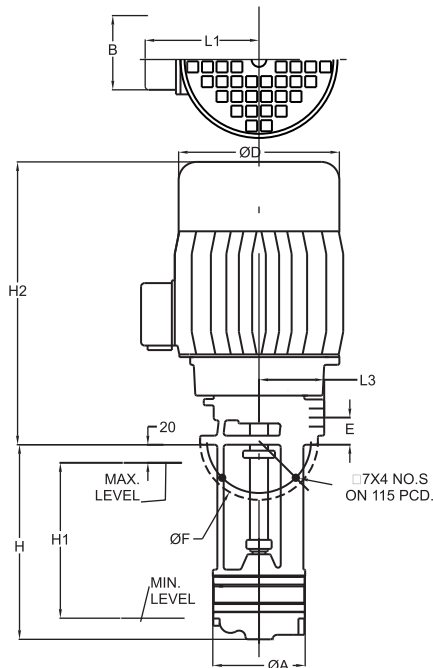

DIMENSIONAL DETAILS

TYPE	No. of Stgs	IMMERSION DEPTH (H)	H1 MAX	H2 MAX	A+0 -1	B MAX	D MAX	d -0.2	d1 BSP	E -0.2	F	L1 MAX	L3	Kw	Wt in Kg
RR50 LP	1	140	100	280	100	72	156	115	G3/4"	30	130	120	70	0.54	18
		190	150												
		240	200												
		290	280												
		370	330												
RR50 HP	1	140	100	305	100	82	156	115	G3/4"	30	130	130	70	0.75	20
		190	150												
		240	200												
		290	280												
		370	330												
RR50-2	2	160	130	335	100	82	170	115	G3/4"	30	130	140	70	1.5	24
		210	180												
		260	230												
		310	300												
		390	360												

* Standard spares : Impeller, Spacer and Bush & Sleeve

RTA SERIES

CONSTRUCTION

Stem	Bronze/S.S
Impeller	Bronze/S.S
Impeller Cover	Bronze/S.S
Shaft	SS410
Bush	Sint. Bronze

OPTIONS

Shaft	S.S
SiC Bush Bearings for long Life	

USED ON

For Temperature controlling units, spindle cooling systems, mould temperature controlling, CNC turning centres, drilling, chilling units and industrial washing machine, etc.

APPLICATION

Types of Fluids	- Water
	- Cooling Emulsions
	- Cooling /Cutting Oils
Kinematical Viscosity	- 90mm ² /s
Pumping Temperature	- 0 -160°C

SPECIAL VERSIONS

To handle liquids upto 250°C

RTA12 - RTA15

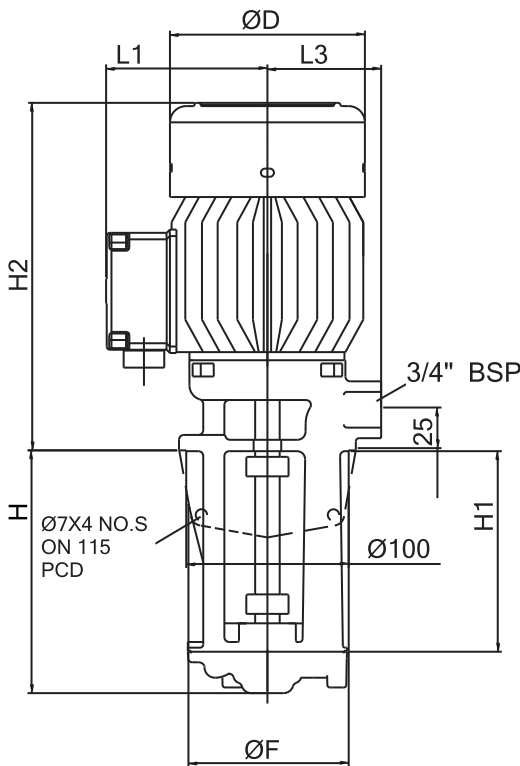

PERFORMANCE GRAPH

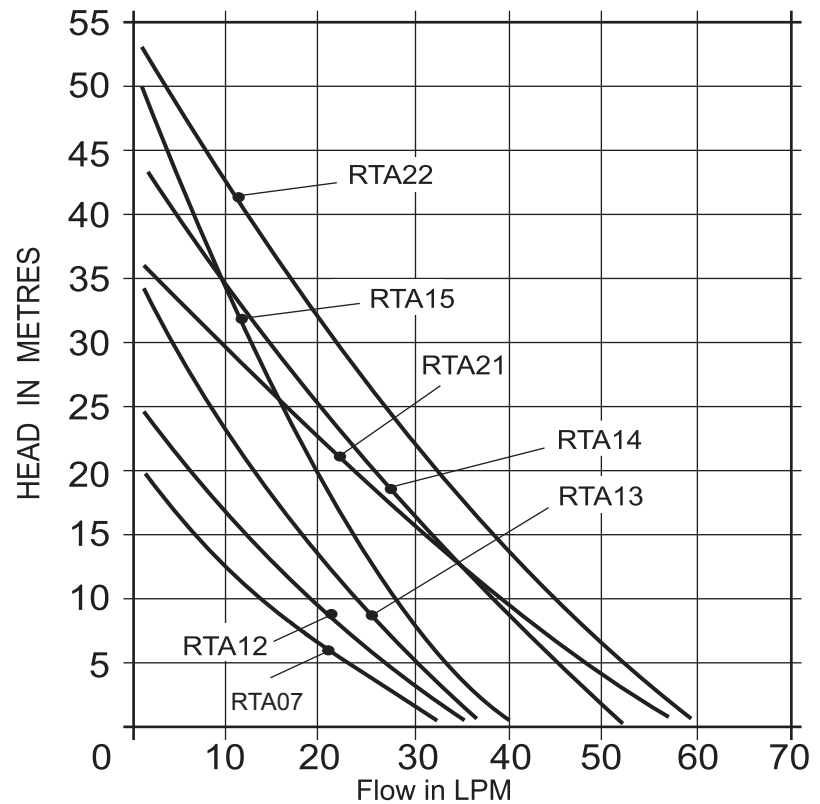

DIMENSIONAL DETAILS

Model	H +/-2	H1 Max	H2 Max	D Max	F	L1 Max	L3 Max	20LPM @ Head (M)	POWER kW	WT. Kg.
RTA07								10	0.18	10.0
RTA12	150	130	215	120	130	100	70	13	0.37	11.5
RTA13								20	0.45	11.5
RTA14									0.50	11.5
RTA15									0.54	11.5
								40LPM @ Head (M)		
RTA21	150	130	230	142	130	120	70	10	0.75	16.0
RTA22								14	0.90	16.0

Motor fitted is suitable for 415 V.50Hz, S1 duty and RPM 2900. Other voltage / freq. motor also available

Standard Spares : Impeller, Bush & Sleeve

MULTISTAGE COOLANT PUMPS RKM025 SERIES

CONSTRUCTION

Stem	C.I.
Impeller	P.P.
Impeller Cover	P.P.
Shaft	SS410
Mechanical Seal	Carbon/Ceramic

OPTIONS

Stem	Gunmetal/SS
Shaft	S.S.
Mechanical Seal	SiC/SiC

APPLICATION

Types of Fluids	- Water / Cooling Emulsion - Cooling/Cutting Oils
Kinematical Viscosity	- 5mm ² /sec
Pumping Temperature	- 0-50°C

SPECIAL VERSIONS

Available

- With Flame Proof Motors to pump hazardous liquids
- With dual speed motor
- With full water proof construction to pump demineralised / deionised water
- Horizontal & Vertical foot mounted

USED ON

Most suited for chilling units, EDM wire cut, spark erosion machines, small CNC lathes and machining centres etc.

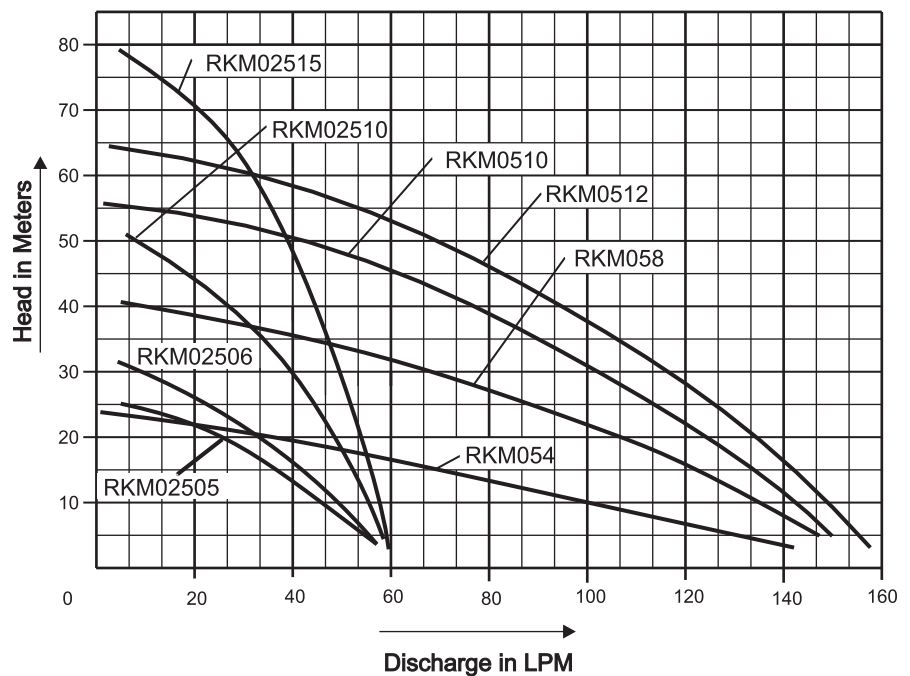
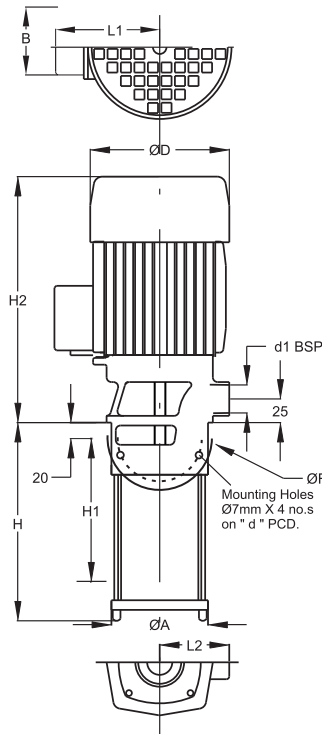

DIMENSIONAL DETAILS

TYPE	NO. OF STAGES	IMMERSION DEPTH (H)	H1 MAX	H2 MAX	A+0 -1	B MAX	D MAX	d -0.2	d1 BSP	S	F	L1 MAX	L2	Kw	Wt in Kg
RKM02505	5	195	140	265	100	68	140	115	G ³ / ₄ "	7	130	110	70	0.37	15
RKM02506	6	220	165	265	100	68	140	115	G ³ / ₄ "	7	130	110	70	0.37	15
RKM02510	10	315	260	320	100	82	160	115	G ³ / ₄ "	7	130	130	70	0.75	22
RKM02515	15	435	380	325	100	82	170	115	G ³ / ₄ "	7	130	140	70	1.5	30
RKM054	4	220	170	235	100	68	140	115	G ³ / ₄ "	7	130	126	70	0.54	16
RKM058	8	360	290	320	100	82	156	115	G ³ / ₄ "	7	130	130	70	0.75	22
RKM0510	10	425	315	320	100	82	156	115	G ³ / ₄ "	7	130	130	70	1.1	22
RKM0512	12	495	415	325	100	82	170	115	G ³ / ₄ "	7	130	140	70	1.5	30

* Standard spares : Impeller Cover, Impeller & Mechanical Seal

MULTISTAGE COOLANT PUMP RKM060 SERIES

CONSTRUCTION

Stem C.I.
 Impeller SS304
 Impeller Cover SS304
 Shaft SS304
 Mechanical Seal Sic/Sic

OPTIONS

Stem Gunmetal/AL./SS
 Mechanical Seal SiC/SiC

APPLICATION

Types of Fluids - Water
 - Cooling Emulsion
 - Cooling/Cutting Oils
 Kinematical Viscosity - 45mm²/sec
 Pumping Temperature - 0-80°C

SPECIAL VERSIONS

Available

- With flame proof motor for hazardous liquids
- With dual speed motor / frequency drive.
- Pressure booster pumps, to increase the pressure (see page no. 5)
- Side suction arrangement (see page no. 5)

USED ON

All CNC machines, lathes, and machining centres.
 Most suited for through tool cooling, deep hole drilling, chilling units, EDM wire cut machines and industrial washing machine.

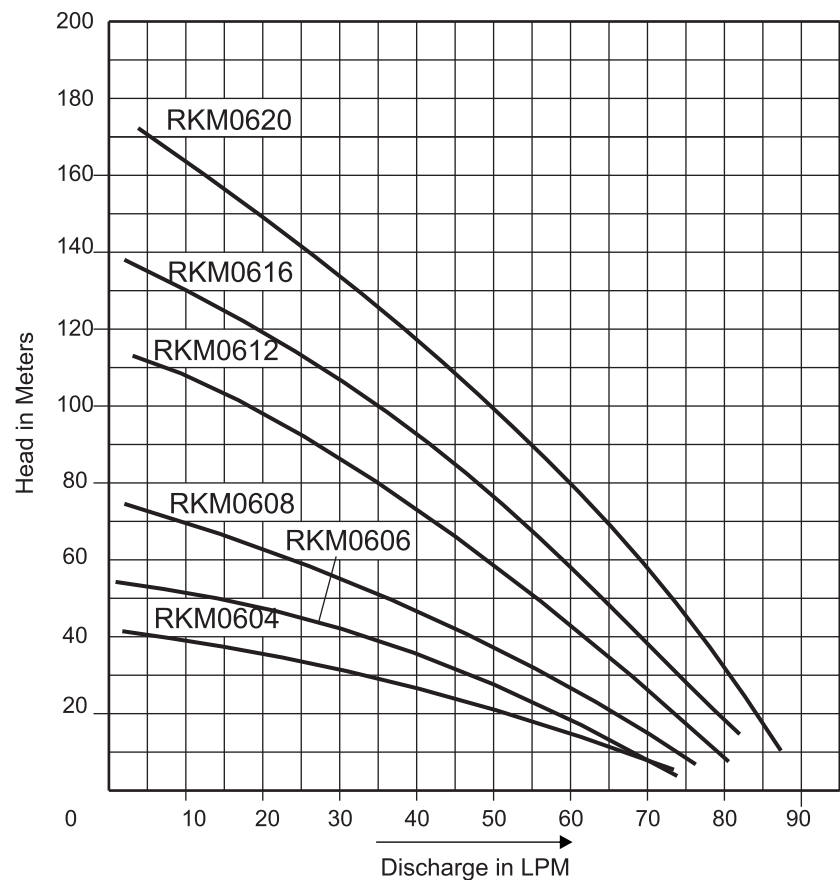
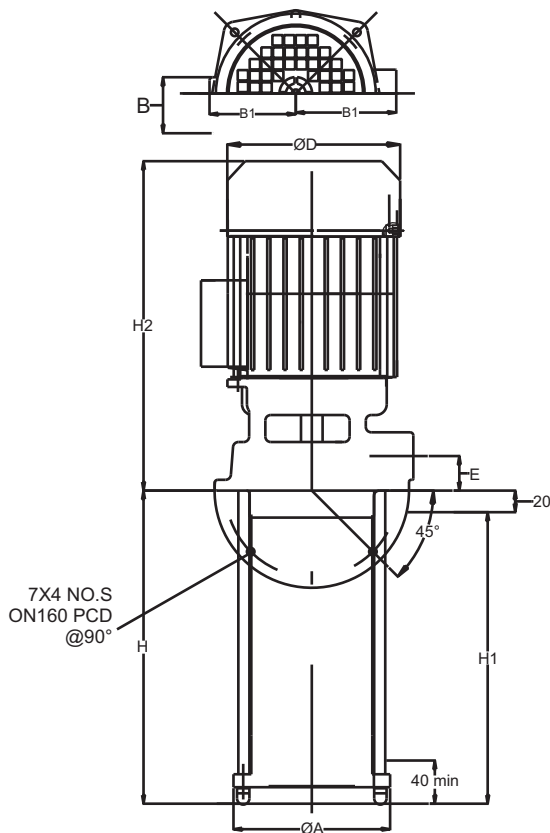

DIMENSIONAL DETAILS

TYPE	No. of Stages	IMMERSION DEPTH (H)	H1 MAX	H2 MAX	A+0 -1	B MAX	D MAX	d -0.2	d1 BSP	E -0.2	F	L1 MAX	L3	Kw	Wt in Kg
RKM0604	4	190	110	220	140	82	140	160	G1"	32	180	110	96	0.54	16.0
RKM0606	6	240	150	270	140	82	156	160	G1"	32	180	120	96	0.75	19.0
RKM0608	8	290	200	270	140	82	156	160	G1"	32	180	120	96	1.0	20.0
RKM0612	12	390	300	430	140	82	170	160	G1"	48	180	150	96	1.50	23.0
RKM0616	16	490	400	430	140	82	170	160	G1"	48	180	150	96	2.6	25.0
RKM0620	20	590	500	460	140	82	206	160	G1"	48	180	160	96	3.0	32.0

* Standard spares : Impeller, Sleeve, Impeller Cover with Bush, Mechanical Seal and spacers

COOLANT PUMPS WITH FLAME PROOF MOTORS - RFP SERIES

These are immersion type centrifugal pumps, suitable to mount a Flame Proof Motor of any standard make, to pump hazardous / flammable liquids. The motor should be of

2800/2P, B5 flange type. The pumps will be provided with parts suitable to handle the liquids that is to be pumped. The coupling will be provided with the pump to couple with the motor.

WITH 71 Fr. FLAME PROOF MOTOR ASSEMBLY

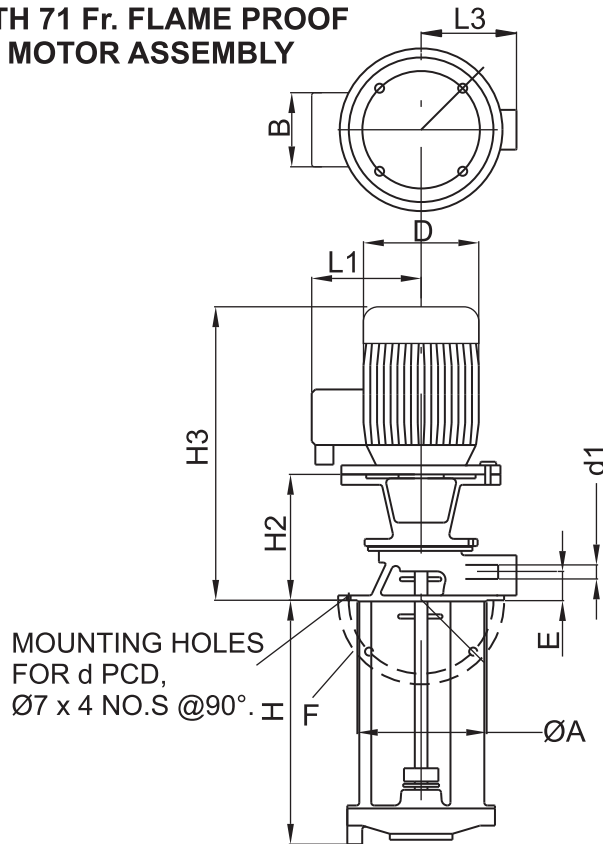

WITHOUT MOTOR ASSEMBLY

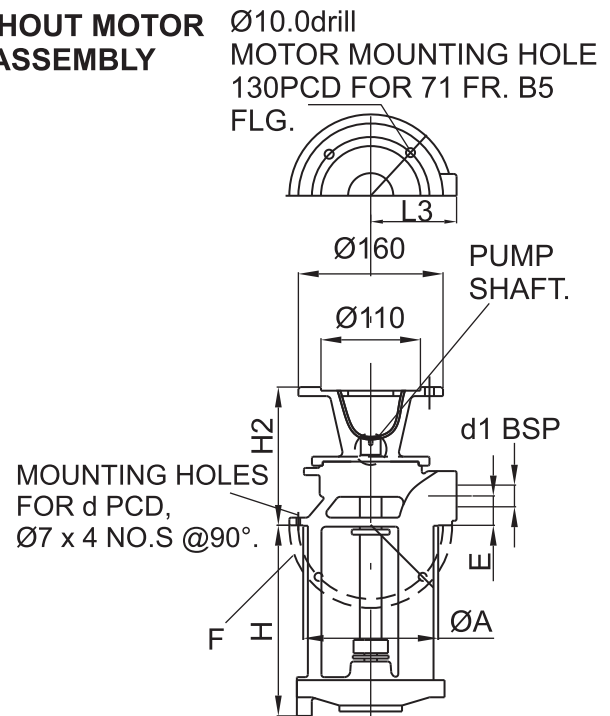

DIMENSIONAL DETAILS

Model	H +/-5	H2	H3	A -1/+0	B Max	D Max	d +/-0.25	d1 BSP	E +/-2	F	L1 Max	L3 Max	POWER kW	WEIGHT in Kg	
														WITH MTR	PUMP ONLY
RFP40/220	225	140	382	100	72	100	115	G3/4"	30	130	130	70	0.18	20.5	5
RFP80/220	215	155	396	140	72	140	160	G1"	32	180	150	100	0.25	31	11
RFP100/270	265	155	396	140	72	140	160	G1"	32	180	150	100	0.25	33	13
RFP160/220	215	155	396	140	72	140	160	G1"	32	180	150	100	0.37	31	11
RFP160/270	265	155	396	140	72	140	160	G1"	32	180	150	100	0.37	33	13

The pumps are suitable for 71 Frame Flame Proof B5 Flange type Motors. Mounting suitable to other Frame size motors or pneumatic motors also can be given. For Performance refer to standard coolant pumps RV Series graph in the respective pages. Any other pumps in this catalog can be given with Flame Proof Motor.

MULTISTAGE COOLANT PUMP RKM100 SERIES

CONSTRUCTION

Stem	C.I.
Impeller	A.L.
Impeller Cover	C.I.
Shaft	EN8
Bush Bearing	GM

OPTIONS

Stem	Gunmetal
Impeller	C.I./Gunmetal/Brass
Impeller Cover	Gunmetal/S.S.
Shaft	S.S. 410
Bush Bearing	SiC/SiC

APPLICATION

Types of Fluids	- Water
	- Cooling Emulsion
	- Cooling/Cutting Oils
Kinematical Viscosity	- 40mm ² /sec
Pumping Temperature	- 0-80°C

SPECIAL VERSIONS

Available

- With Flame Proof Motors to pump hazardous liquids
- With dual speed motor

USED ON

All CNC machines lathes and machining centres. Most suited for through tool cooling, deep hole drilling etc. Also suitable for Industrial washing.

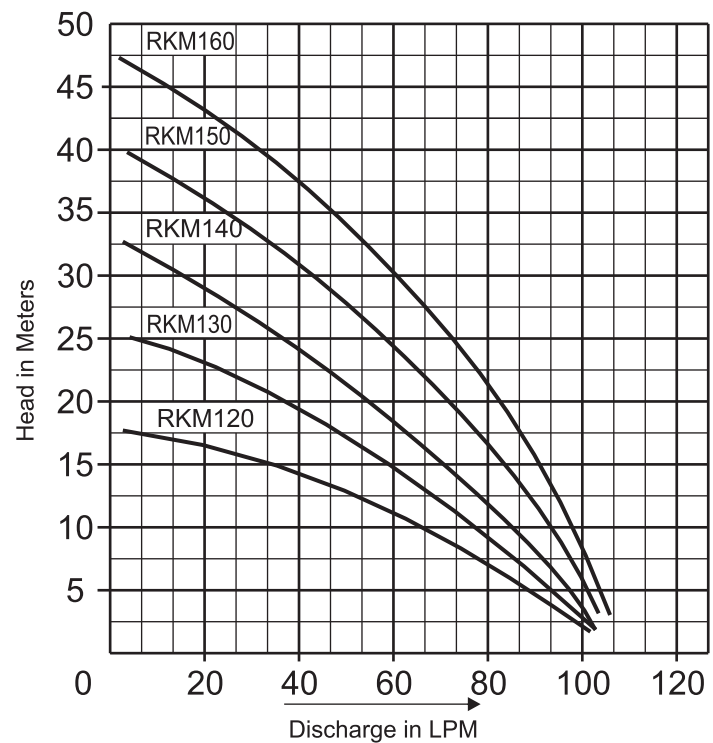
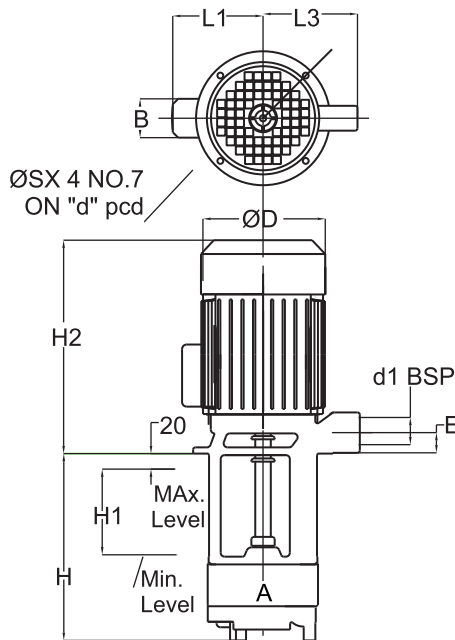

DIMENSIONAL DETAILS

Type	No. of Stages	Immersion Depth H	H1 Max	H2 Max	A+0 -1	B Max	D Max	d -0.2	d1 BSP	E	F	L1 Max	L3	Power in KW	WT in KG
RKM-120	2	215 265 315	160 225 275	225	140	82	140	160	G1"	30	180	110	110	0.5	20
RKM-130	3	230 300 350	130 160 210	245	140	82	157	160	G1"	30	180	120	110	0.9	31
RKM-140	4	265 335 385	150 225 275	355	140	82	170	160	G1"	30	180	130	110	1.5	40
RKM-150	5	320 390 440	150 220 270	355	140	82	170	160	G1"	30	180	130	110	1.7	42
RKM-160	6	360 430 480	150 330 380	425	140	82	190	160	G1"	30	180	155	110	2.25	46

* Standard spares : Impeller, Spacers and Bush & Sleeve

MULTISTAGE COOLANT PUMPS RKM200 & RKM300

CONSTRUCTION

Stem	C.I.
Impeller	S.S./C.I
Impeller Cover	C.I.
Guide vane	Noryl-30% GF
Shaft	EN8
Mechanical Seal	SiC/SiC
Bush/Sleeve	Carbon/Carbon

OPTIONS

Stem	Gunmetal
Impeller Cover	Gunmetal/S.S.
Shaft	S.S.
Mechanical Seal	SiC/SiC (for Grinding)
Bush/Sleeve	SiC/SiC

APPLICATION

Types of Fluids	- Water
	- Cooling Emulsion
	- Cooling/Cutting Oils
Kinematical Viscosity	- 40mm ² /sec
Pumping Temperature	- 0-50°C

SPECIAL VERSIONS

Available

- With Flame Proof Motors to pump hazardous liquids
- With dual speed motor
- Booster arrangement (see page 5)
- Side suction arrangement (see page 5)
- Upto 6 Stages available in Horizontal construction

USED ON

All CNC machines lathes and machining centres. Most suited for through tool cooling, deep hole drilling etc. Also suitable for Industrial washing, grinding Machine.

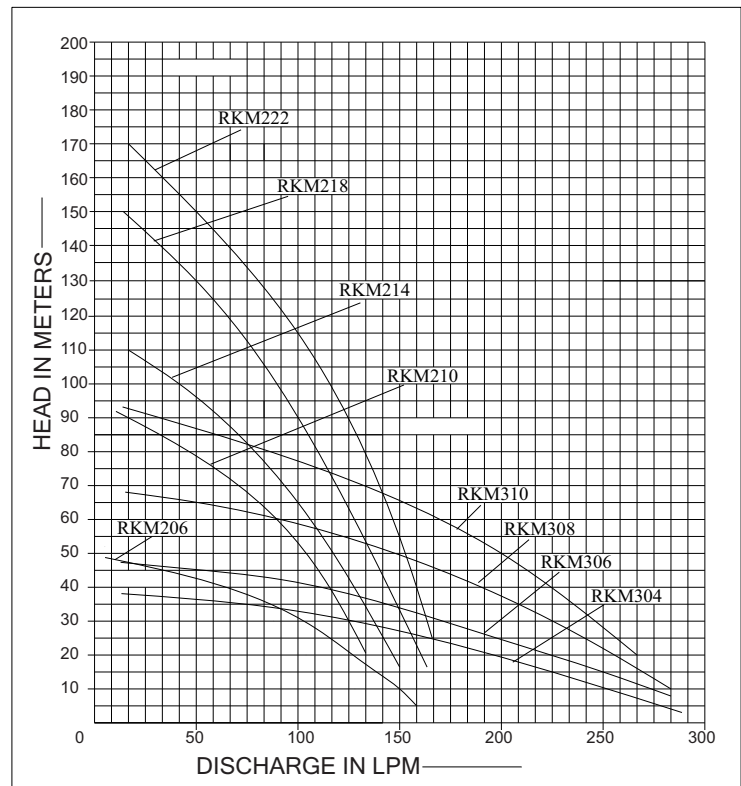
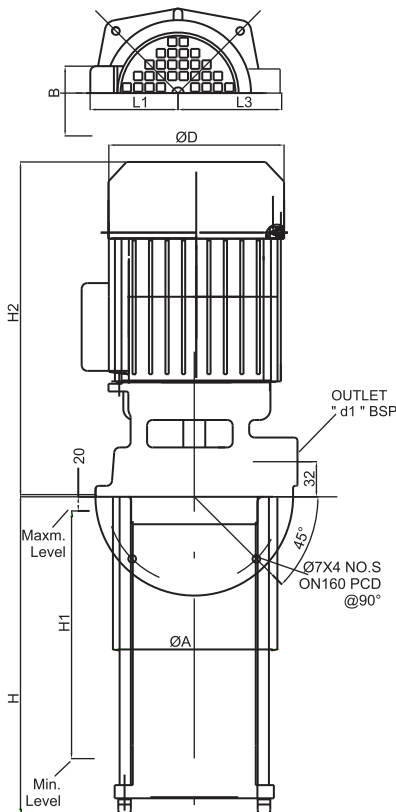

TYPE	NO OF STAGES	IMMERSION DEPTH H	H1 MAX	H2 MAX	A+0 -1	B MAX	D MAX	d ±0.2	d1 BSP	S	F	L1 MAX	L2	Kw	WEIGHT in Kg
RKM-206	6	270	180	325	140	82	208	160	G1"	7	180	150	110	1.5	35.5
RKM-210	10	405	320	410	140	100	225	160	G1"	7	180	150	110	3.0	67.0
RKM-214	14	545	480	410	140	100	225	160	G1"	7	180	215	110	4.0	90.0
RKM-218	18	685	580	410	140	100	225	160	G1"	7	180	220	110	5.5	113.0
RKM-222	22	825	720	480	140	110	280	160	G1"	7	180	150	110	7.5	80.0
RKM-304	4	250	120	410	140	82	208	160	G1"	7	180	150	110	2.25	60.0
RKM-306	6	340	210	410	140	100	225	160	G1"	7	180	150	110	3.0	51.0
RKM-308	8	430	300	470	140	110	280	160	G1"	7	180	210	110	3.7	90.0
RKM-310	10	500	370	470	140	110	280	160	G1"	7	180	210	110	5.5	80.0

* Standard spares : Impeller, Bush & Sleeve, Mechanical Seal and spacers

MULTISTAGE COOLANT PUMP RKM250 SERIES

CONSTRUCTION

Stem	C.I.
Impeller	AL.
Impeller Cover	C.I.
Shaft	EN8
Bush Bearing	Carbon/GM

OPTIONS

Stem	Gunmetal
Impeller	C.I./Gunmetal
Impeller Cover	Gunmetal
Shaft	S.S.410
Bush Bearing	Carbide

APPLICATION

Types of Fluids	- Water
	- Cooling Emulsion
	- Cooling/Cutting Oils
Kinematical Viscosity	- 90 mm ² /s
Pumping Temperature	- 0-80°C

SPECIAL VERSIONS

Available

- With flame proof motor for hazardous liquids
- With dual speed motor

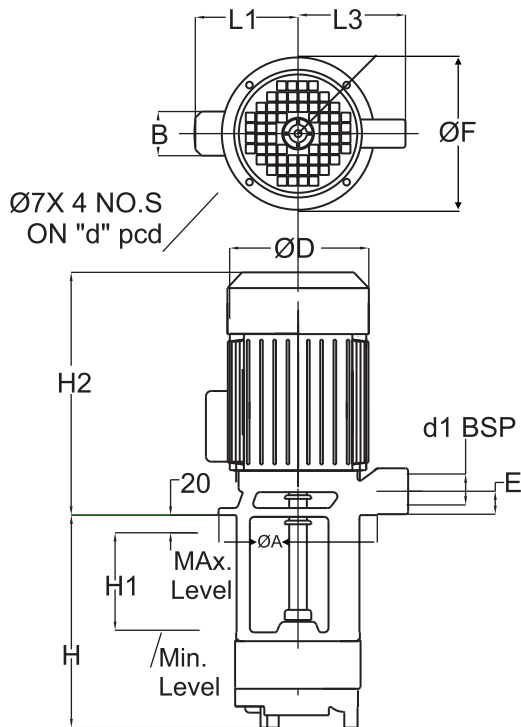

USED ON

All CNC machines, lathes, and machining centres. Most suited for through tool cooling, deep hole drilling, chilling units and industrial washing machine, grinding machine.

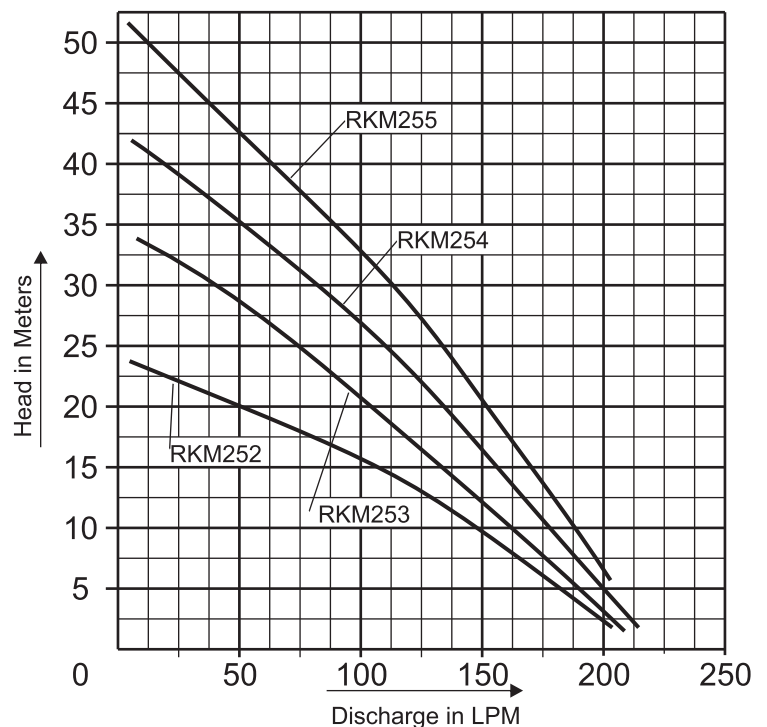

DIMENSIONAL DETAILS

TYPE	No. of Stages	IMMERSION DEPTH H	H1 MAX	H2 MAX	A+0 -1	B MAX	D MAX	d -0.2	d1 BSP	E+0 -1	F	L1 MAX	L3	Kw	Wt in Kg
RKM-252	2	150	95	140	140	75	157	160	G1¼"	20	180	126	110	1.1	26
		205	135	245	140	79	140	160	G1¼"	30	180	120	110	0.9	30
		280	205	245			140	140				120			24
		330	255	245			140	140							34
RKM-253	3	265	190	345								140			31
		335	260	340	140	79	178	160	G1¼"	30	180	140	85	1.5	34
		385	310	345											35
RKM-254	4	320	240	360											41
		390	310	360	140	79	178	160	G1¼"	30	180	140	110	1.7	46
		440	380	360											47
RKM-255	5	375	295	410								150			52
		445	365	410	140	82	208	160	G1¼"	30	180	150	110	2.25	54
		495	435	410								150			55

* Standard spares : Impeller, Bush & Sleeve, Mechanical Seal and spacers



RTH2, RTH4 & RTH6 Series

APPLICATION

- Types of Fluids - Water / Cooling Emulsion
 - Cooling/Cutting Oils
 With spl. Constrn. - Light Chemicals
 - Washing solutions
 Kinematical Viscosity - 45 CST
 Pumping Temperature - 0 – 80°C

USED ON

All CNC machines, lathes and machining centres. Most suited for through tool cooling, deep hole drilling, chilling units and industrial washing machine temperature controlling units etc.

SPECIAL VERSIONS

- With frequency drive
- With Dual speed Motor

CONSTRUCTION

Stem	C.I.	Impeller cover	S.S. 316
Impeller	S.S. 316	Mechanical Seal	SiC/SiC
		Shaft	S.S. 316

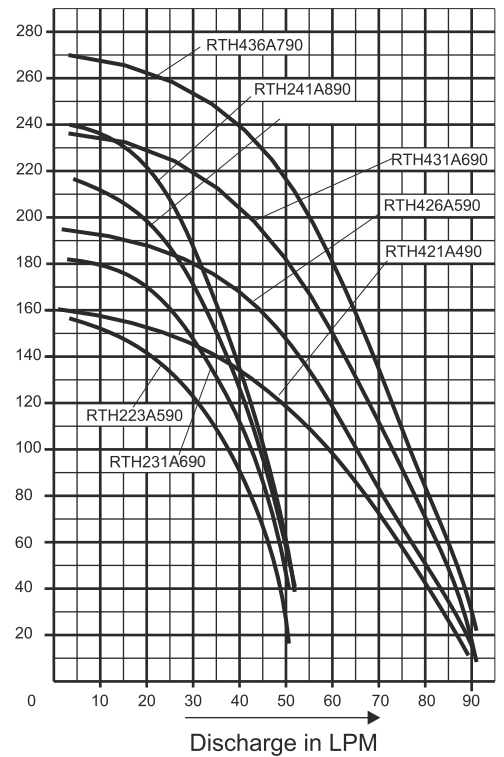
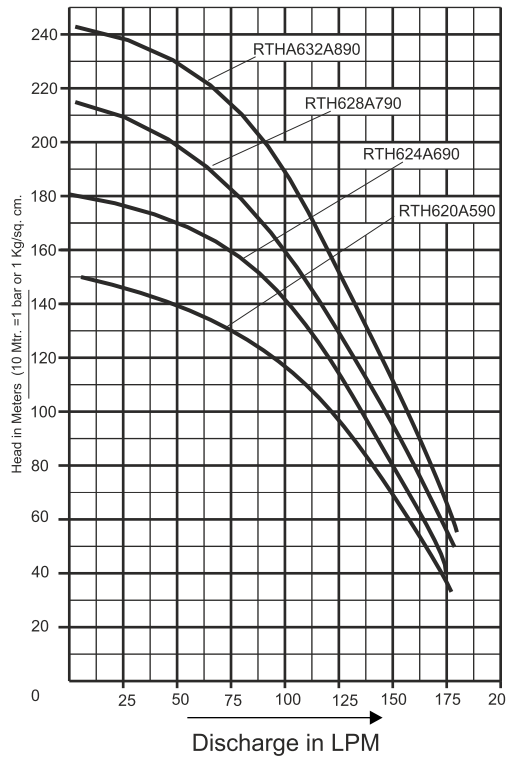
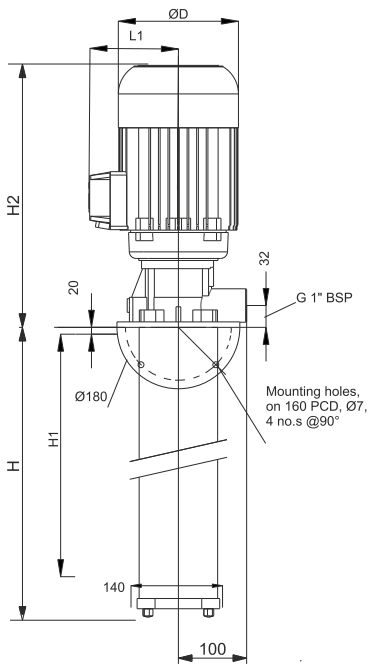

DIMENSIONAL DETAILS

Model	H +/-2	H1 Max	H2 Max	D Max	L1 Max	POWER kW	LPM/HEAD
RTH223A590	590	500	340	200	126	1.1	20 / 125
RTH231A690	690	600	395	175	150	1.7	20 / 172
RTH236A790	790	700	395	175	165	2.0	20 / 200
RTH241A890	890	800	410	200	150	2.2	20 / 225
RTH421A490	490	400	395	175	150	2.0	40 / 136
RTH426A590	590	500	410	200	150	2.25	40 / 168
RTH431A690	690	600	410	200	150	2.6	40 / 208
RTH436A790	790	700	410	200	150	3.3	40 / 248
RTH620A590	590	500	410	200	150	3.0	80 / 128
RTH624A690	690	600	410	200	150	3.3	80 / 155
RTH628A790	790	700	430	230	180	3.7	80 / 180
RTH632A890	890	800	430	230	180	4.0	80 / 206

Note : Standard Motors will be single speed 2,800 RPM. Dual Speed Motor is on request

* Standard spares : Impeller, Sleeve, Impeller Cover with Bush, Mechanical Seal and spacers

HIGH PRESSURE HIGH DISCHARGE COOLANT PUMPS RMS400... 800

CONSTRUCTION

Stem	C.I.
Impeller	C.I.
Impeller Cover	C.I.
Shaft	EN8
Bush/Sleeve	EN31/EN24

OPTIONS

Stem	Gunmetal
Impeller	C.I./Gunmetal
Impeller Cover	Gunmetal
Shaft	S.S.
Bush/Sleeve	Carbide

APPLICATION

Types of Fluids	- Water
	- Cooling Emulsion
	- Cooling/Cutting Oils
Kinematical Viscosity	- 90 mm ² /s
Pumping Temperature	- 0-80°C

SPECIAL VERSIONS

Available

- With flame proof motor for hazardous liquids.
- to handle larger chips for transfer to filtration unit.
- Immersion dept in step 200mm available other than standard

USED ON

All CNC machines, lathes, machining centres, Most suited for grinding m/c.s, filtration units chip conveyors, washing machines, etc.

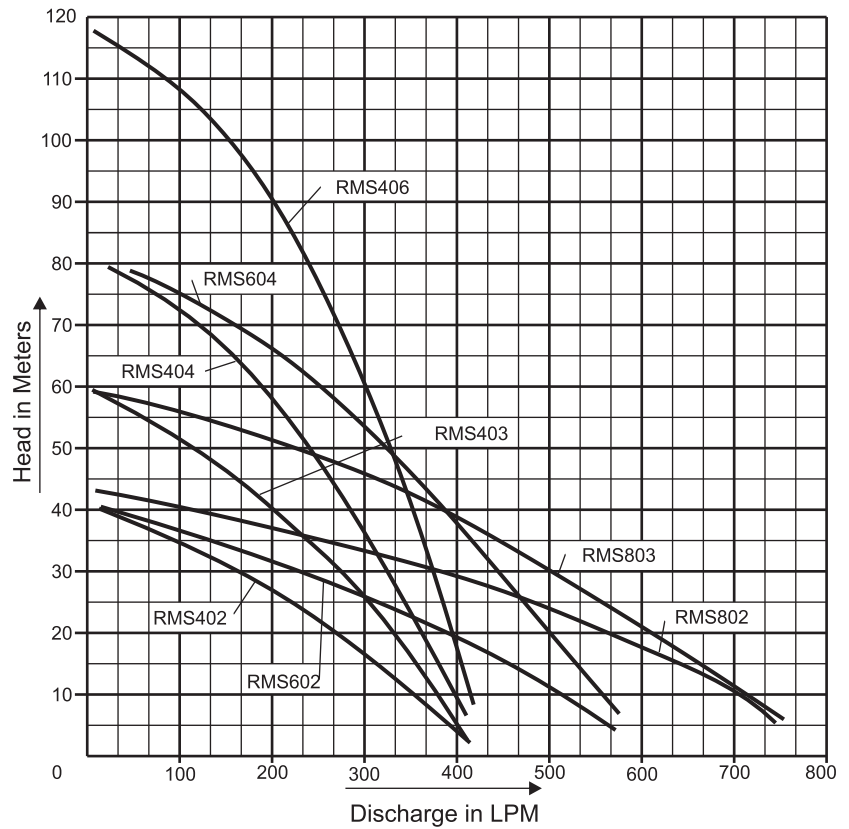
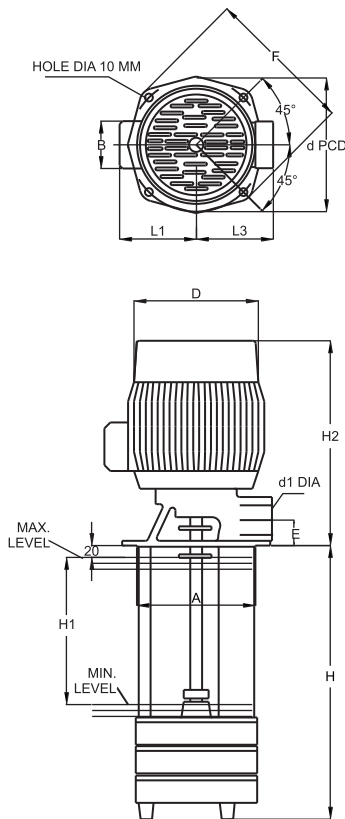

DIMENSIONAL DETAILS

TYPE	No. of Stages	IMMERSION DEPTH H	H1 MAX	H2 MAX	A+0 -1	B MAX	D MAX	d -0.2	d1 BSP	E+0 -1	F	L1 MAX	L3	Kw	Wt in Kg
RMS-402	2	375	295	410	200	82	156	225	G1½"	42	250	150	126	3.0	59
RMS-403	3	450	370	435	200	82	225	225	G1½"	42	250	170	126	4.0	79
RMS-404	4	525	445	470	200	82	230	225	G1½"	42	250	180	126	5.5	107
RMS-406	6	675	595	470	200	82	200	225	G1½"	42	250	180	126	7.5	125
RMS-602	2	375	295	470	200	82	230	225	G2"	42	250	190	126	4.0	70
RMS-604	4	525	445	470	200	82	230	225	G2"	42	250	190	126	7.5	106
RMS-802	2	375	295	470	200	82	230	225	G2"	42	250	190	126	7.5	91
RMS-803	3	450	370	470	200	82	230	225	G2"	42	250	190	126	9.0	110

* Standard spares : Impeller, Bush & Sleeve

MULTISTAGE HORIZONTAL COOLANT PUMP RMH0250 SERIES

CONSTRUCTION

Suction cover C.I.
 Impeller Noryl
 Delivery cover C.I.
 Impeller Cover Noryl
 Shaft SS410

OPTIONS

Suction cover S.S/Brass/Gunmetal
 Delivery cover S.S/Brass/Gunmetal

APPLICATION

Types of Fluids - Water
 - Cooling Emulsion
 - Cooling/Cutting Oils
 With spl. Constr. - Light Chemicals
 - Washing solutions
 Kinematical Viscosity - $1\text{mm}^2/\text{sec}$ (Max. $10\text{mm}^2/\text{sec}$)
 Pumping Temperature - 0 – 50°C

SPECIAL VERSIONS

- Available
- With flame proof motor for hazardous liquids
 - 1 PH 2, 230V, 50 Hz

USED ON

All CNC machines, lathes, and machining centres. Most suited for washing machines, Electrochemical deburring machine, drilling, chilling units, Descaling etc.

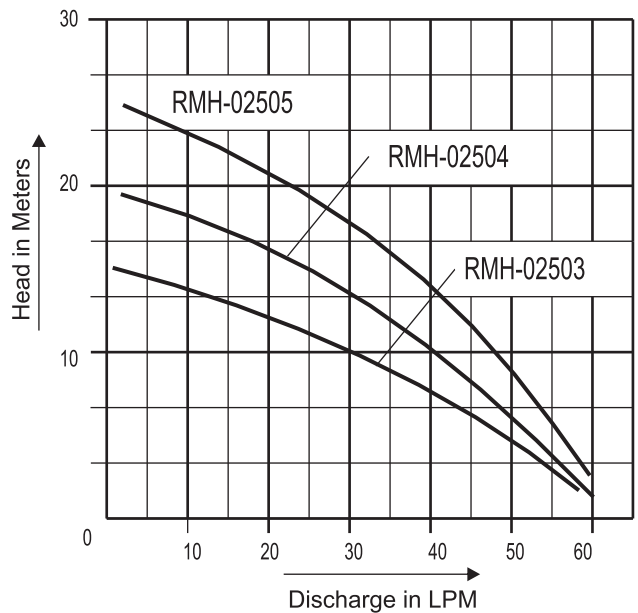
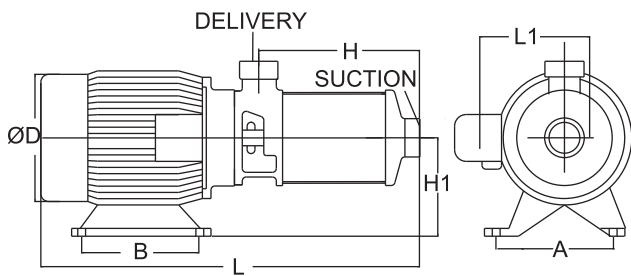

DIMENSIONAL DETAILS

Model	H	H1	A	B	D Max	L Max	L1 Max	POWER kW
RMH02503	146	63	100	80	114	300	95	0.18
RMH02504	170	73	112	90	140	375	110	0.25
RMH02505	195	71	112	90	140	400	110	0.37

* Standard spares : Impeller, Bush & Sleeve, Mechanical Seal, O-rings and spacers

MULTISTAGE HORIZONTAL COOLANT PUMP RMH060 SERIES

CONSTRUCTION

Suction cover C.I.
 Impeller SS316
 Delivery cover C.I.
 Impeller Cover SS304
 Shaft SS410
 Mechanical seal Carbon/Ceramic

OPTIONS

Suction cover S.S/Brass/Gunmetal
 Delivery cover S.S/Brass/Gunmetal
 Mechanical seal SiC/SiC

APPLICATION

Types of Fluids - Water
 - Cooling Emulsion
 - Cooling/Cutting Oils
 With spl. Constrn. - Light Chemicals
 - Washing solutions
 Kinematical Viscosity - 1mm²/sec (Max.10mm²/sec)
 Pumping Temperature - 0 – 80°C

SPECIAL VERSIONS

Available

- With flame proof motor for hazardous liquids

USED ON

All CNC machines, lathes, and machining centres. Most suited for washing machines, Electrochemical deburring machine, drilling, chilling units, Descaling, etc.

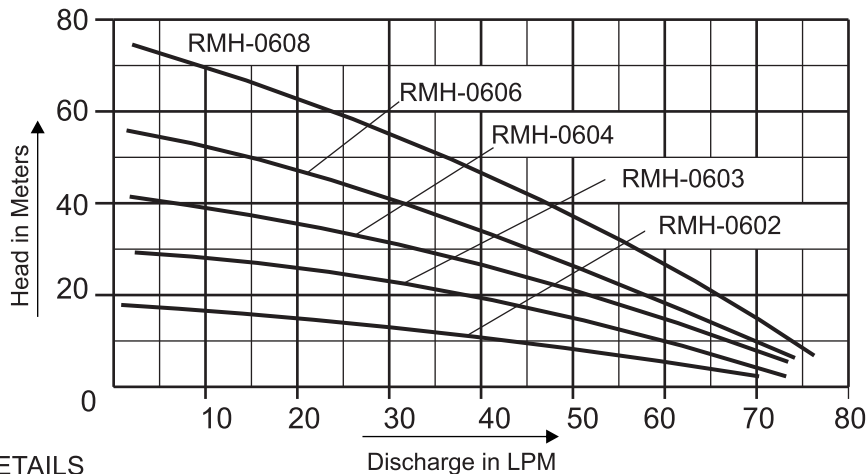
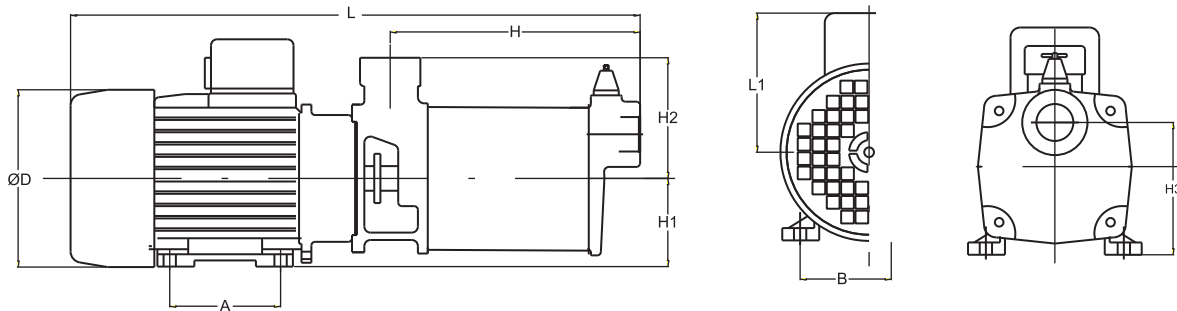

DIMENSIONAL DETAILS

Model	H	H1	H2	H3	A	B	D Max	L Max	L1 Max	POWER kW
RMH0602	155	71	98	100	112	90	140	395	115	0.25
RMH0603	180	71	98	100	112	90	140	475	115	0.37
RMH0604	205	71	98	100	112	90	140	500	115	0.54
RMH0606	230	80	98	115	125	100	165	560	125	0.75
RMH0608	255	80	98	115	125	100	165	610	125	1.10

(Dimension A & B are mounting holes for the pump/ SUCTION & DELIVERY of G1"BSP, female threading)

- also available with 1 PHASE 230V 50HZ CAPACITOR START/RUN MOTOR.

* Standard spares : Impeller, Bush & Sleeve, Mechanical Seal, O-rings and spacers

RTAH- ALL S.S. HORIZONTAL PUMPS

CONSTRUCTION

Delivery Cover SS316
Suction Cover SS316
Impeller Brass
Shaft SS410
Mechanical Seal SiC/SiC
O Ring NEOPRENE

APPLICATION

Types of Fluids - Coolant Emulsion/ Oils
- Diesel/Kerocene
- Chemicals-Acids/Alkalis
- Water/DM Water
Temperature - 0-80°C

USED ON

Very ideal for pumping clean water or light chemicals for circulation in small Chilling units, Small SPMs, Fuel circulation, etc.

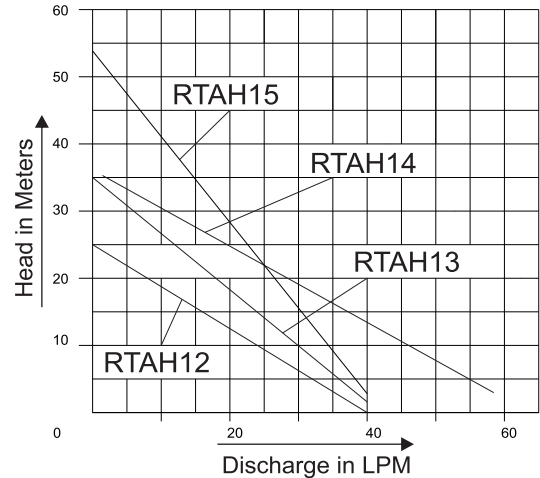
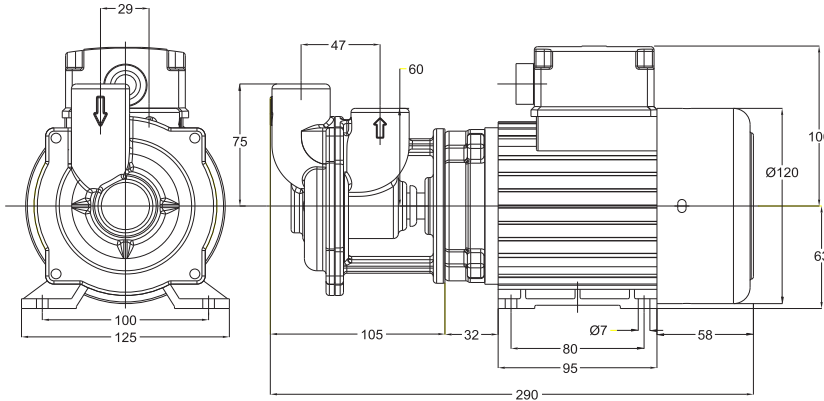

RKH- HORIZONTAL PUMPS

CONSTRUCTION

Delivery Cover CI
Suction Cover CI
Impeller CI/SS
Shaft SS410
Mechanical Seal SiC/SiC
O Ring NEOPRENE

APPLICATION

Types of Fluids - Coolant Emulsion/Oils
- Washing media-Alkalis
- Water
Temperature - 0-80°C

USED ON

Very ideal for pumping clean coolant or oil for cutting application, washing machines, EDM wirecut & Spark Erosion machines.

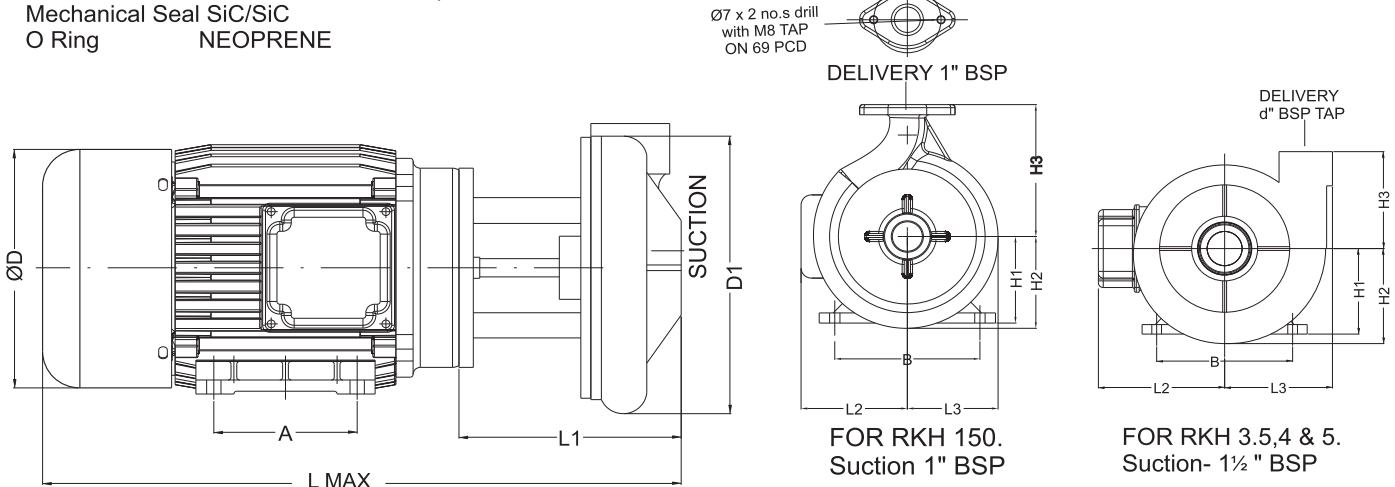

FOR RKH 150.
Suction 1" BSP

FOR RKH 3.5,4 & 5.
Suction- 1½" BSP

Model	ØD	L MAX	L1	D1	L2	L3	A	B	H1	H2	H3	KW	Wt. (app.) kg
RKH 3.5	160	400	115	188	135	111	100	125	81	100	102	0.75	25
RKH 4	170	400	115	188	135	111	100	125	81	100	102	1.1	25
RKH 5	170	450	115	188	135	111	100	140	90	100	102	1.5	30
RKH 150	142	360	130	175	140	88	90	112	71	90	130	0.54	25

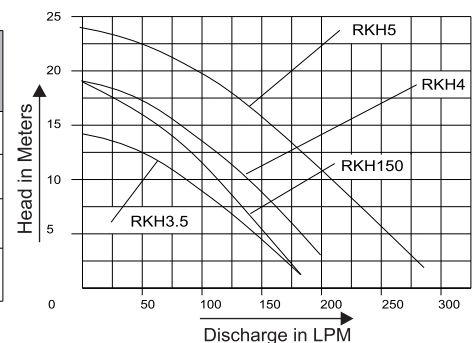

NEW

SELF PRIMING COOLANT PUMP- RSP SERIES

CONSTRUCTION

Pump Housing C.I.
Stem C.I.
Impeller C.I.
Shaft EN8

OPTIONS

Impeller SS304/316 / Gunmetal
Shaft S.S.304/316

APPLICATION

Types of Fluids - Water
- Cooling Emulsions
- Cooling /Cutting Oils
Kinematical Viscosity - 90mm² / s
Pumping Temperature - 0 – 90°C

SPECIAL VERSIONS

Available
* With flame proof motor for hazardous liquids
* Suitable for VFD duty/ Any voltage/Freq. motors
* For dry running- to keep the pump on continuously.

USED ON

Filtration systems, Chip conveyors, CNC/VMC Machines, Grinding machines to transfer contaminated liquids. Can handle chips upto 3mm.

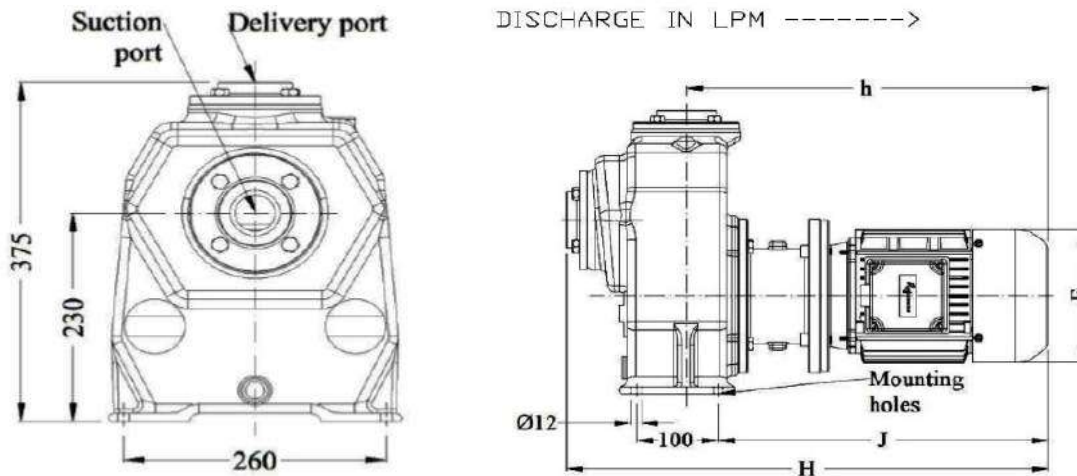
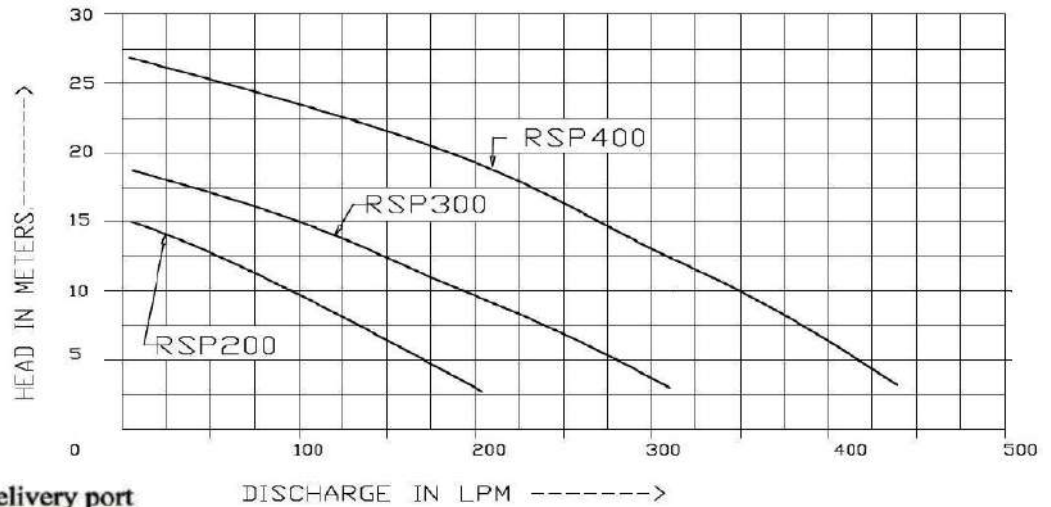

DIMENSIONAL DETAILS

Model	H	J	h	F Dia.	Mounting Holes	Suction Port	Delivery Port	Power kW	Weight Kg.
RSP200	580	395	434	160	Dia.12 X 4 no's	G 1 ½"	G 1 ½"	0.75	44
RSP300	590	405	444	176		G 1 ½"	G 1 ½"	1.5	51
RSP400	770	479	630	200		G 2"	G 1 ½"	2.25	56

HIGHER FLOW RATE PUMPS ON REQUEST. ALL DIMENSIONS ARE IN MM AND RPM AT 2900

- STANDARD SPARES: IMPELLER, MECHANICAL SEAL.

OIL SKIMMERS - ROS SERIES

CONSTRUCTION

Support Assembly	Powder coated
Belt	PU
Wiper	Teflon
Drive Pulley	SS410
Driven Pulley	Nylon

OPTIONS

Motor Body	SS316/304
Support Assembly	SS316/304
Belt	PVC/SS316
Driven Pulley	SS316/304
Oil collection separation tray	SS316/304

APPLICATION

Types of Fluids	- Oils - Coolant Emulsion - Mild Chemicals
Liquid Temperature	- 0-50°C for PU Belt 100°C for SS Belt

STANDARD ACCESSORIES

- TIMER - FOR ROS1 & ROS2

USED ON

OPTIONAL

VFD for 3Ph
(1Ph input / 3Ph output) for speed control

All CNC machines, conventional machines, washing machine, electro plating grinding machines etc. Where floating oil is to be extracted for better life of coolant and finish of components.

ROS1-40

1 Phase, Belt Skimmer

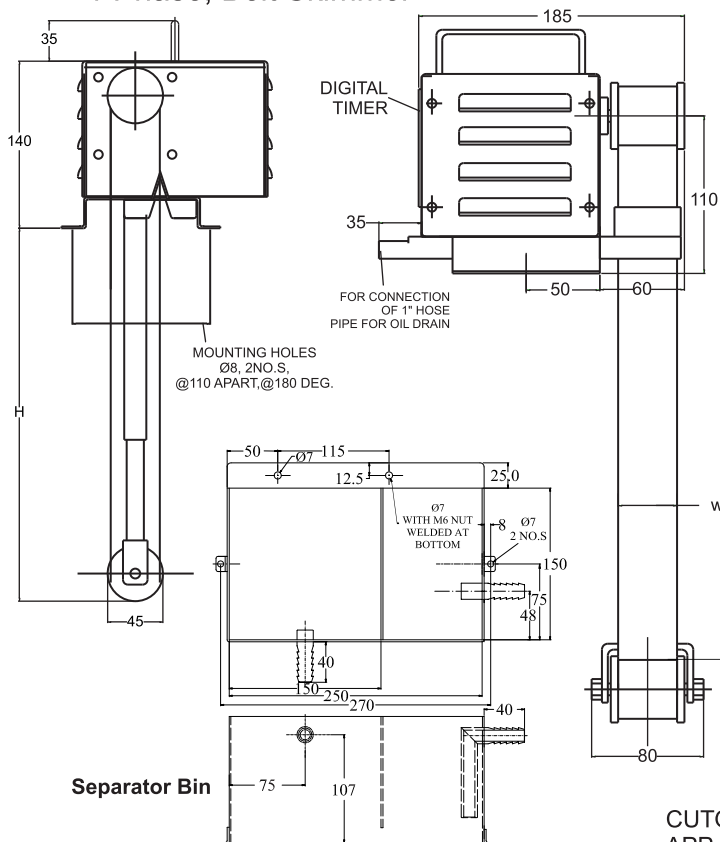

ROS3/5

3 Phase, Belt Skimmer / Hinged Belt

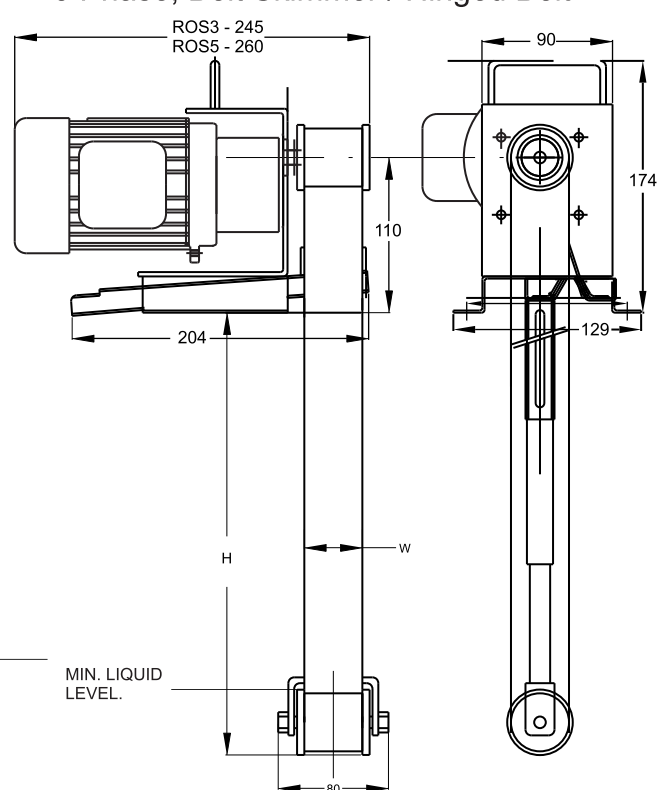

CUTOUT SIZE:
APP. 75 X 55 STD. 40 MM WIDTH BELT.

Available Models

- ROS1 Single Phase Belt type skimmers
- ROS2 Single Phase Disc skimmers small diam. disc. max. 300mm
- ROS3 Single Phase Disc skimmers
- ROS4 Single Phase Disc skimmers for bigger diam. with low speed.
- ROS5 SS Hinged belt type skimmers

Ask for detailed catalogue from factory or download from the website.

HIGH PRESSURE SCREW PUMPS BFS, BFG & FFS SERIES

2-pole motor rotation speed 2900 RPM					
Pressure max.	Flow at viscosity		Power consumption at viscosity		Motor immersion version
	1 mm ² /s	20 mm ² /s	1 mm ² /s	20 mm ² /s	
Type / bar	l/min	l/min	kW	kW	kW
BFS,BFG, FFS / 130	Q _{Th} ¹⁾ 15.6	–	–	–	–
10	14.0	15.0	0.5	0.5	B 1.3
20	13.1	14.6	0.8	0.8	B 1.3
30	12.1	14.2	1.0	1.0	B 1.3
40	11.2	13.9	1.3	1.3	B 1.3
50	10.3	13.5	1.5	1.6	B 1.7
60	9.5	13.2	1.8	1.9	B 1.9
70	8.7	12.8	2.1	2.1	B 2.2
80	7.9	12.5	2.3	2.4	B 2.6
90	7.1	12.1	2.6	2.7	B 3.3
100	6.4	11.8	2.8	2.9	B 3.3
110	–	11.5	–	3.2	B 3.3
120	–	11.2	–	3.5	B 4.0
130	–	10.9	–	3.8	B 4.0
140	–	10.6	–	4.0	B 4.0
150	–	10.3	–	4.3	B 5.5

BFS,BFG, FFS / 140	Q _{Th} ¹⁾ 20.9	–	–	–	–
10	18.8	20.1	0.6	0.7	B 1.3
20	17.5	19.5	0.9	1.0	B 1.3
30	16.3	19.0	1.3	1.4	B 1.5
40	15.1	18.5	1.6	1.7	B 1.9
50	14.0	18.0	2.0	2.1	B 2.2
60	13.0	17.6	2.3	2.5	B 2.6
70	12.0	17.1	2.7	2.8	B 3.3
80	11.1	16.6	3.0	3.2	B 3.3
90	10.3	16.2	3.4	3.5	B 4.0
100	9.5	15.7	3.7	3.9	B 4.0
110	–	15.3	–	4.3	B 5.5
120	–	14.8	–	4.6	B 5.5
130	–	14.4	–	5.0	B 5.5
140	–	14.0	–	5.3	B 5.5
150	–	13.6	–	5.7	B 7.5

BFS,BFG, FFS / 232	Q _{Th} ¹⁾ 26.1	–	–	–	–
10	24.3	25.4	0.7	0.8	B 1.3
20	23.6	25.2	1.1	1.3	B 1.3
30	23.0	24.9	1.5	1.7	B 1.9
40	22.4	24.6	2.0	2.2	B 2.6
50	21.8	24.4	2.4	2.7	B 3.3
60	21.2	24.1	2.8	3.1	B 3.3
70	20.6	23.9	3.3	3.6	B 4.0
80	20.0	23.6	3.7	4.0	B 4.0
90	19.5	23.3	4.1	4.5	B 5.5
100	18.9	23.1	4.6	4.9	B 5.5
110	18.4	22.9	5.0	5.4	B 5.5
120	17.8	22.6	5.5	5.8	B 7.5
130	17.3	22.4	5.9	6.3	B 7.5
140	16.7	22.1	6.3	6.7	B 7.5
150	16.2	21.9	6.8	7.2	B 7.5

2-pole motor rotation speed 2900 RPM					
Pressure max.	Flow at viscosity		Power consumption at viscosity		Motor immersion version
	1 mm ² /s	20 mm ² /s	1 mm ² /s	20 mm ² /s	
Type / bar	l/min	l/min	kW	kW	kW
BFS,BFG, FFS / 238	Q _{Th} ¹⁾ 31.0	–	–	–	–
10	28.8	30.1	0.7	0.7	B 1.3
20	28.1	29.8	1.3	1.3	B 1.3
30	27.4	29.5	1.8	1.8	B 1.9
40	26.7	29.2	2.3	2.4	B 2.6
50	26.0	28.9	2.8	2.9	B 3.3
60	25.3	28.7	3.3	3.5	B 4.0
70	24.6	28.4	3.8	4.0	B 4.0
80	23.9	28.1	4.4	4.5	B 5.5
90	23.2	27.8	4.9	5.1	B 5.5
100	22.5	27.6	5.4	5.6	B 7.5
110	21.9	27.3	5.9	6.2	B 7.5
120	21.2	27.0	6.4	6.8	B 7.5
130	20.6	26.7	6.9	7.3	B 7.5
140	19.9	26.5	7.5	7.9	B 10.0
150	19.3	26.2	8.0	8.4	B 10.0

BFS,BFG, FFS / 250	Q _{Th} ¹⁾ 40.8	–	–	–	–
10	37.9	39.6	0.9	0.9	B 1.3
20	37.0	39.2	1.6	1.6	B 1.7
30	36.0	38.9	2.3	2.3	B 2.6
40	35.1	38.5	3.0	3.1	B 3.3
50	34.3	38.1	3.6	3.8	B 4.0
60	33.5	37.7	4.3	4.5	B 5.5
70	32.7	37.4	5.0	5.2	B 5.5
80	31.9	37.0	5.7	5.9	B 7.5
90	31.2	36.6	6.4	6.6	B 7.5
100	30.5	36.2	7.0	7.4	B 7.5
110	–	35.9	7.7	8.1	B 10.0
120	–	35.5	8.4	8.8	B 10.0
130	–	35.1	9.1	9.5	B 10.0
140	–	34.7	9.8	10.2	–
150	–	34.3	10.4	11.0	–

BFS,BFG, FFS / 260	Q _{Th} ¹⁾ 48.9	–	–	–	–
10	45.5	47.4	1.0	1.1	B 1.5
20	44.3	46.9	1.9	2.0	B 2.2
30	43.2	46.3	2.7	2.9	B 3.3
40	42.0	45.7	3.5	3.8	B 4.0
50	40.9	45.1	4.3	4.6	B 5.5
60	39.7	44.5	5.1	5.5	B 7.5
70	38.5	43.9	5.9	6.4	B 7.5
80	37.4	43.3	6.8	7.3	B 7.5
90	36.2	42.6	7.6	8.1	B 10.0
100	35.0	42.0	8.5	9.0	B 10.0
110	–	41.4	9.3	9.9	B 10.0
120	–	40.7	10.0	10.8	–

¹⁾ Q_{Th}: Theoretical flow rate
Higher pressures (up to 200 bar) upon request

HIGH PRESSURE SCREW PUMPS BFS, BFG & FFS SERIES

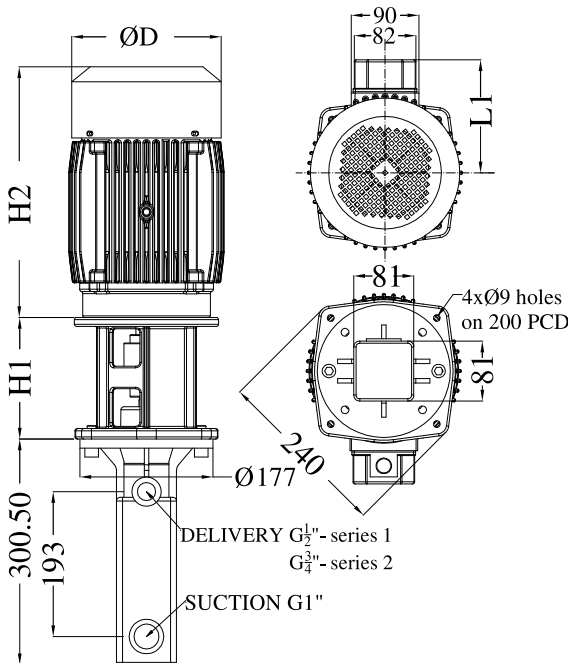

MTR FR	ØD	H1	H2	L1
100 FR	Ø199	162	334	150.5
112 FR	Ø242	162	351	174
132 FR	Ø262	182	365	185

Pump Type	Description	Application
BFS	SiC Housing for Screw Spindles	For all Application/ Pressure Upto 150 bar.
BFG	Hardened SG Iron Housing for Screw Spindles	Except for Aluminium & Grinding / Pres Below 50 Bar
FFS	Horizontal mounting (with mechanical seal)	For all Application/ Pressure Upto 150 bar.

Special Version	Details	Optional	Standard
KBT5	Coted Main Spindle & screw Housing	BFS1, BFS2,TFS3	TFS4-TFS6
N	Coated Outer female Support Spindles	BFS1, BFS2,TFS3-TFS5	TFS6
A	Axial Thrust Compensasion	BFS1, BFS2	TFS3-TFS5
G	With Mechanical seal- outside mounting	BFS1, BFS2,TFS3-TFS5	TFS6
G4	Positive suction Pressurem(7-20 bar)- with leakage port.	BFS1, BFS2,TFS3,TFS4	NA

High Flow Pumps-STA,SFL,TAL

- Range** : for Coolant emulsion: 1000-2600 LMP
- Pressure** : 4 Bar
- Motor Power** : 2.6-21.5 kW.
- Application** : Machining, Grinding, Filtration, Chip conveying, flooding.
- Special Versions** : for foamed coolants, dirty liquids upto 20 mm chip sizes, quick suctioning.
- Features** : Very rugged construction, very low maintenance, can handle almost all sort or contamination / chip types found in machine tool industry, non-clogging type impellers, no mechanical seal-ensure longer life span, space saving immersion type design, available with frequency drive or pole changing motor to save power.



Chip Cutter Pumps-SFC



- Range** : for Coolant emulsion 1000-2600 LPM
- Pressure** : 4 Bar
- Motor Power** : 2.6-21.6 kW.
- Chip handling** : Aluminum chips of any size
- Application** : Filtration, Chip conveying
- Special Version** : Any range & type of pump can be given with this attachment.
- Features** : Very specially designed cutters for long life, stirrer to cut the bundled chips, requires no extra effort to take out chips from the tank or machining area filtration can be simplified.

RAJAMANE RPP - ALL POLYPROPELENE PUMPS

ASK for More details

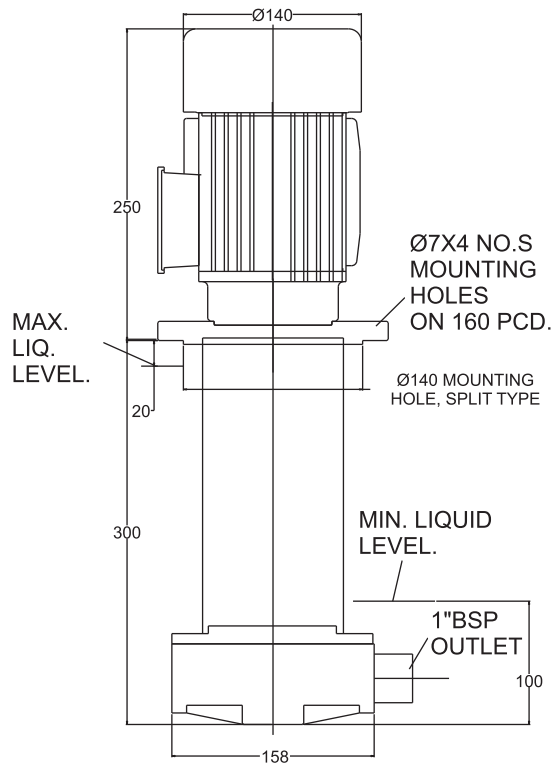

RPP160 in vertical immersion type.
All wet ends in poly-propelene.

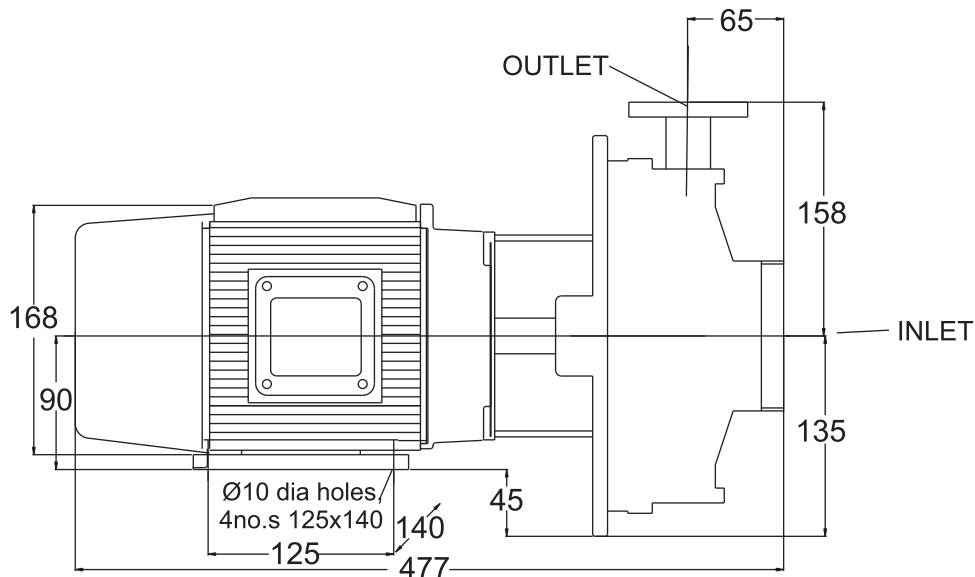

RPP5 in horizontal mounting.
All wet parts in poly-propelene.

Flow : 400 LPM Max Head : 30 MTR. Max in both version

Inline Pumps



Application:

- ✦ Industrial Washing Machines
- ✦ RO Plants
- ✦ Machine tools
- ✦ High Rise Buildings
- ✦ Fire Fighting
- ✦ Process Industries



**RSB, RSBI, RSBN Series
Performance range 50 Hz**

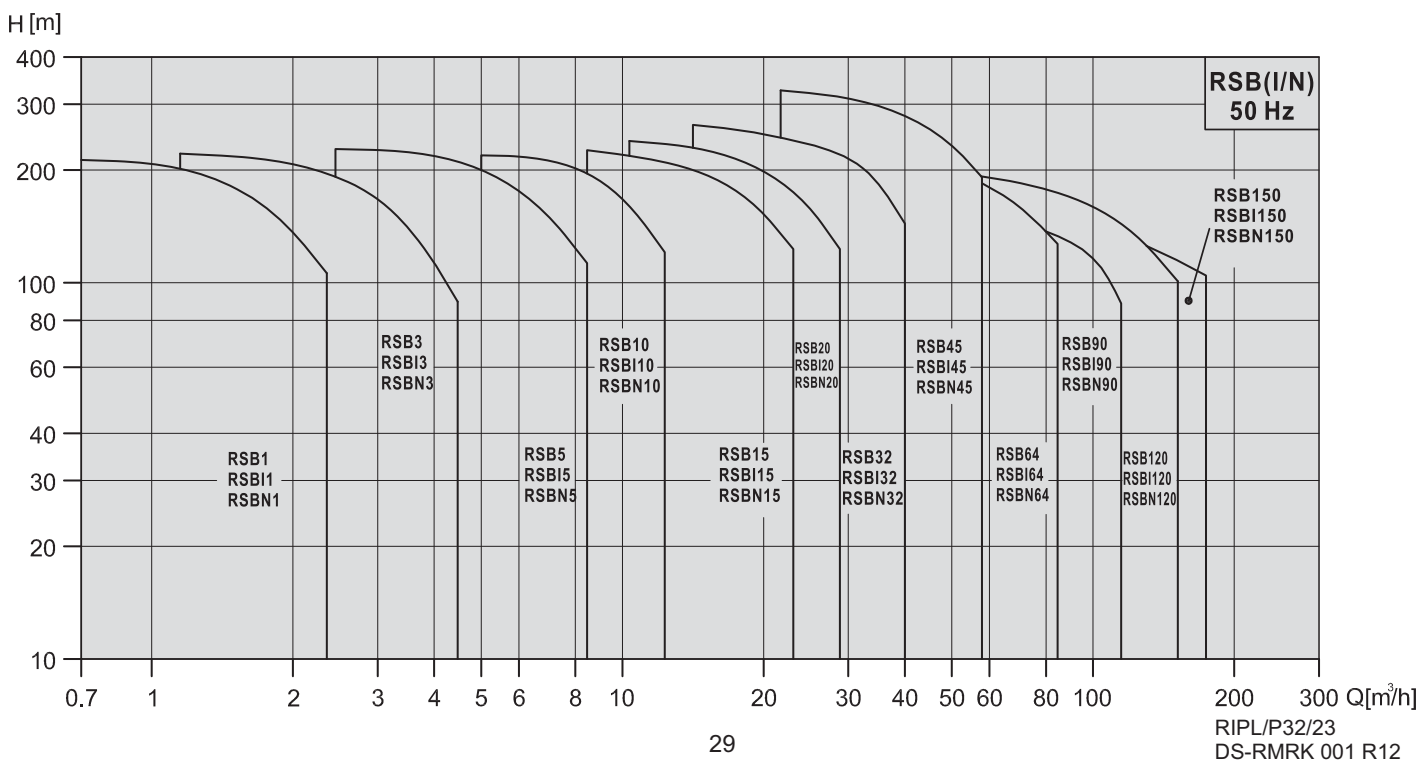

High Pressure Piston Pumps

Range: 1LPM 10 bar to 150 LPM 500 bar



Application:

- ▶ Chip Breaking
- ▶ Gun Drilling
- ▶ Through tool Cooling
- ▶ High Pressure Washing
- ▶ Mist Cooling and many more

Pump Construction in - Brass & Stainless Steel | Operating Temperature upto 85°C

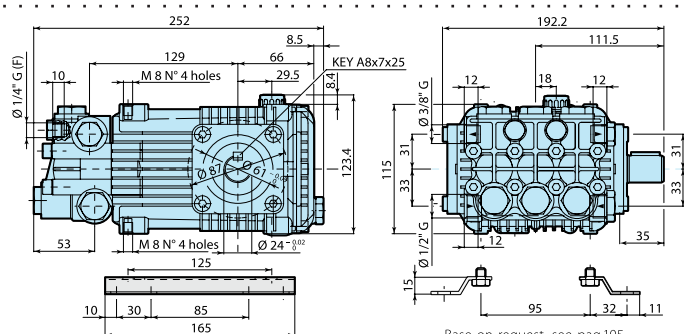
RK 11.20 H N

Base on request, see pag.105.

Piedi a richiesta, vedi pag.105.

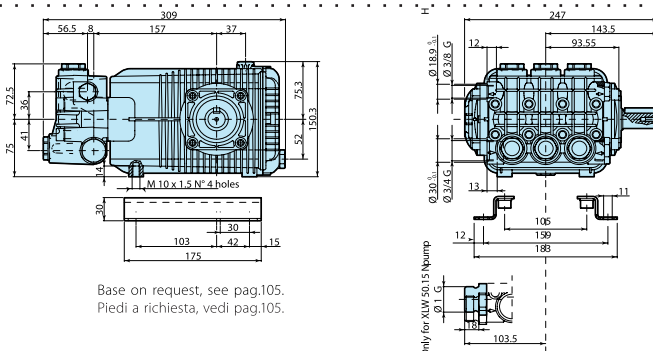
WHWL 50.15 N

Base on request, see pag.105.

Piedi a richiesta, vedi pag.105.

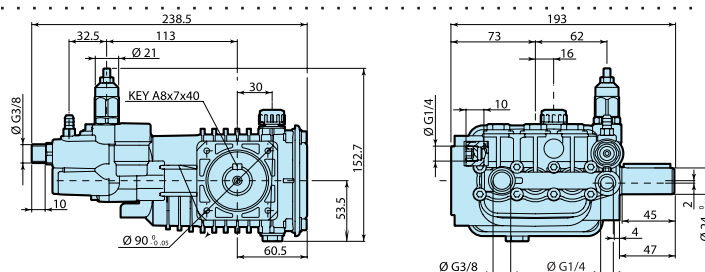
RS 15.15 N

Pump	Cod.	Output		Pressure		Power		RPM	Weight Kg
		l/min	gpm	bar	psi	hp	kw		
RK 11.20 H N	20631	11	2.90	200	2900	5.5	4	1450	9
WHWL 50.15 N	23968	50	13.20	150	2200	20	15	1450	16,5
RS 15.15 N	22054	15	3.96	150	2200	5.5	4	1450	7

 Over 100 + models
to choose from
ask detailed catalog

Accessories :



Pressure regulating unloader valve



Head gun kit



Gun kit for wash

 3/8" high pressure hose with couplings
RIPL/P32/23
DS-RMRK 001 R12

OTHER SPECIALITY PRODUCTS

Custom made Motors



Dual Speed Motors



Torque Motors



Single phase Motors with controls / VFD

Motors are manufactured as per customers requirements. Some of the specially designed & manufactured motors are :

1. Torque motors for indexing, compact gear boxes
2. Long shaft motors for looms & cheese widers
3. Dual speed motors for pumps, automats, gear boxes etc.
4. Fractional HP motors - for centralized lubrication systems, circuit breaks, panel cooling, small ovens etc.
5. Single phase motors - with ON/Off controls, VFD drives for various industrial application, in 2 & 4 poles.
6. Standard induction motors - In all mountings & IE2 efficiency for any voltage & frequency



Cheese winder motor



Fractional HP Motors

& many more....



Standard foot mounted motors

RVP - Refueling pumps



RVP pump with Kit

RVP - Refueling pumps with accessories are available with 3 phase, 1 phase AC induction motors. Also available for vehicle mounting with DC 12V/24V motors. This finds usefull on gensets, earth moving vehicles for refueling. Ask for detailed Catalog.



BLDC Motors / Actuators



BLDC motors and actuators are custom made designs. Available with drives for any voltages - AC or DC. Typical application will be valves, small automations, EGR Valves etc.

Coolant pump with VFD motor

VFD -fitted to motor, for driving the pump, at various heads. This will save power, increase tool life, reduces coolant heating. Available upto 10kW, for all coolant pumps. The pressure can be directly set through CNC program for each tool.



High pressure pump with VFD mounted motors

Auto Electric Parts

Starter coil, alternate stators, starter housing with brush plate - manufactured as per requirement.



Alternator



Starter Housing with Brush



Starter Coil

Specification / Dimensions are subject to change due to Continuous improvement in the products

DEALER NETWORK

▲ Factory / Head Office

● Dealers / Representative



Rajamane Foundry

200 ton FG/SG Grades and

Non-Ferrous 10 Ton

Ask For Detailed catalog

Dealer :

Manufacturer:

Rajamane Industries Pvt. Ltd.,

Whitefield Road, Mahadevapura Post,

Bangalore - 560 048. India

Ph.: +91 80 4365 9000 Fax: +91 80 2852 4320

E-mail: coolantpump@rajamane.com

Web: www.rajamane.co